



**INSTALLATION
GUIDE MANUAL FOR
COMMERCIAL
INDUSTRIAL HF 1000**

Edmonton, Alberta, Canada
Ph: (780) 955-6363
Fax: (780) 955-6377

PROFILE

IMP VERTICAL WALL PANELS

APPLICATION

COMMERCIAL - INDUSTRIAL

DETAIL

HIDDEN FASTENER PANEL PROFILE

TYPE

HF-1000

DATE

MAY 1/22

REV.

A

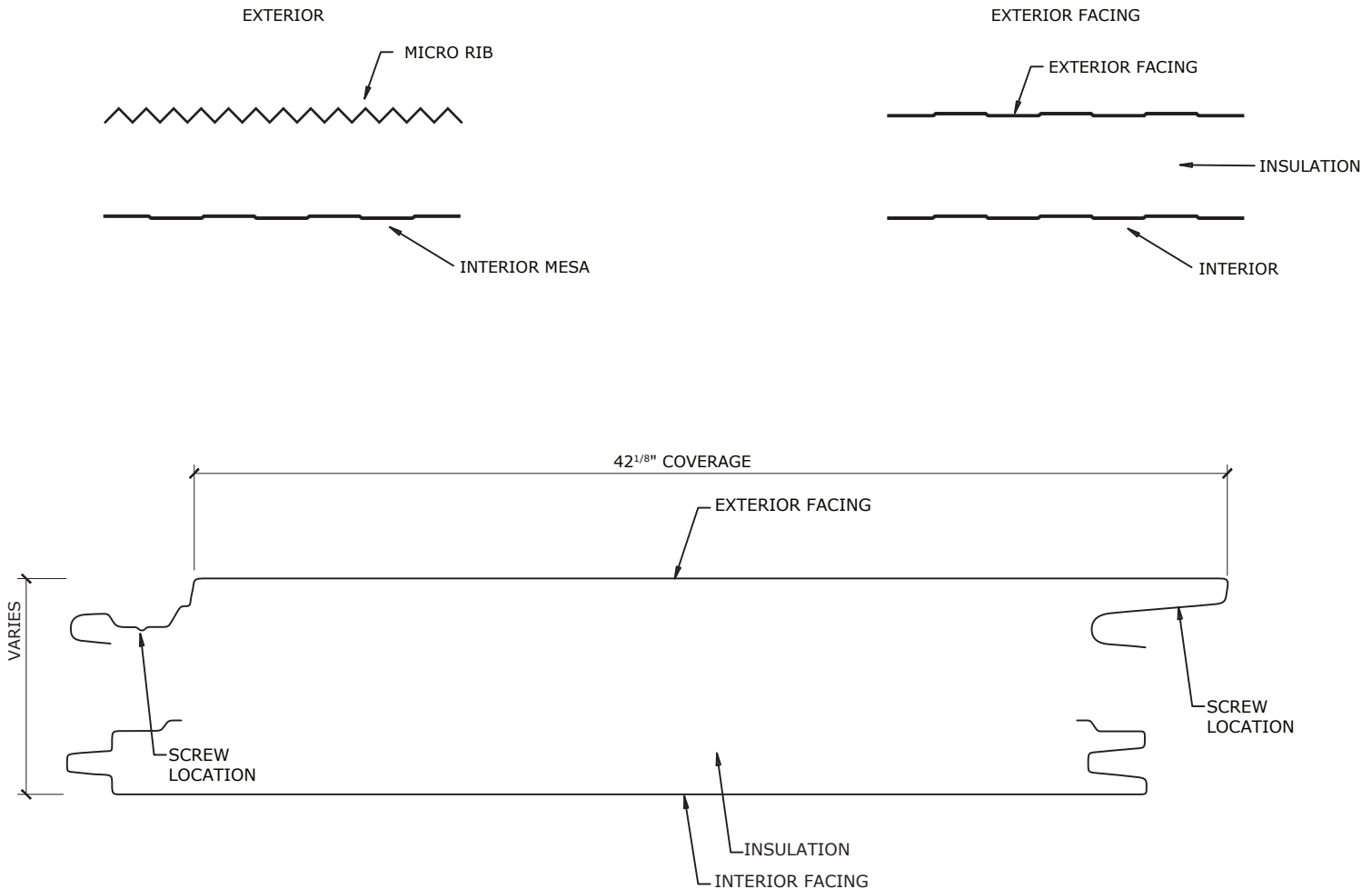

VERTICAL WALL PANEL

WIDTH: 42^{1/8}"
 PROFILE: MESA/MESA, MICRO RIB/MESA
 INSULATION THICKNESS: 3"
 EXTERIOR FACING: 24ga, 26ga
 INTERIOR FACING: 24ga, 26ga
 AVAILABLE FINISHES: SMOOTH, EMBOSSED

DISCLAIMER

THE DETAILS ARE PROVIDED FOR REFERENCE AND AS A GUIDELINE TO INDUSTRY ACCEPTED PRACTICES FOR SIMPLE BUILDING CONDITIONS. THESE DETAILS DO NOT ADDRESS ALL BUILDING TYPES, CONDITIONS OR DESIGN. THE DETAILS MUST BE CHECKED FOR SUITABILITY AND MODIFIED BASED ON THE PROJECTS INTENDED USE, LOCATION, AND DESIGN LOADS.

A QUALIFIED DESIGN PROFESSIONAL SHOULD BE CONSULTED TO ENSURE MATERIALS, PRODUCTS, AND DESIGN COMPLY WITH APPLICABLE CODES, REGULATIONS, AND STANDARDS. THIS INCLUDES CORRECT PLACEMENT OF SEALANTS, LOCATION OF AIR/VAPOUR BARRIERS AND PROJECT SPECIFIC DESIGN LOADS REQUIRED BY CODE TO MEET THE REQUIREMENTS FOR THE LOCAL AUTHORITIES HAVING JURISDICTION.

STRUCTURAL SUPPORTS AND CONNECTIONS ARE SHOWN FOR ILLUSTRATION PURPOSES ONLY. CONSTRUCTION DRAWINGS GOVERN OVER THESE DETAILS.

ADVANCED PANEL CONTINUES TO REFINE AND IMPROVE BASED ON CHANGES TO THE INDUSTRY. ADVANCED PANEL AND ITS AFFILIATED COMPANIES AND SUPPLIERS RESERVE THE RIGHT TO CHANGE DETAILS, SPECIFICATIONS, DESIGNS, OR PRODUCTS AT ANY TIME. PLEASE CONTACT ADVANCED PANEL OR YOUR LOCAL REPRESENTATIVE FOR THE LATEST INFORMATION AVAILABLE.

NOTES:

A. DETAILS ARE FOR GUIDELINES ONLY, AND MAY NOT BE SUITABLE FOR ALL BUILDING DESIGNS AND CONDITIONS.

PROFILE

IMP VERTICAL WALL PANELS

APPLICATION

COMMERCIAL - INDUSTRIAL

DETAIL

HIDDEN FASTENER PANEL PROFILE - SERIES 1

TYPE

HF-1000

DATE

MAY 1/22

REV.

A

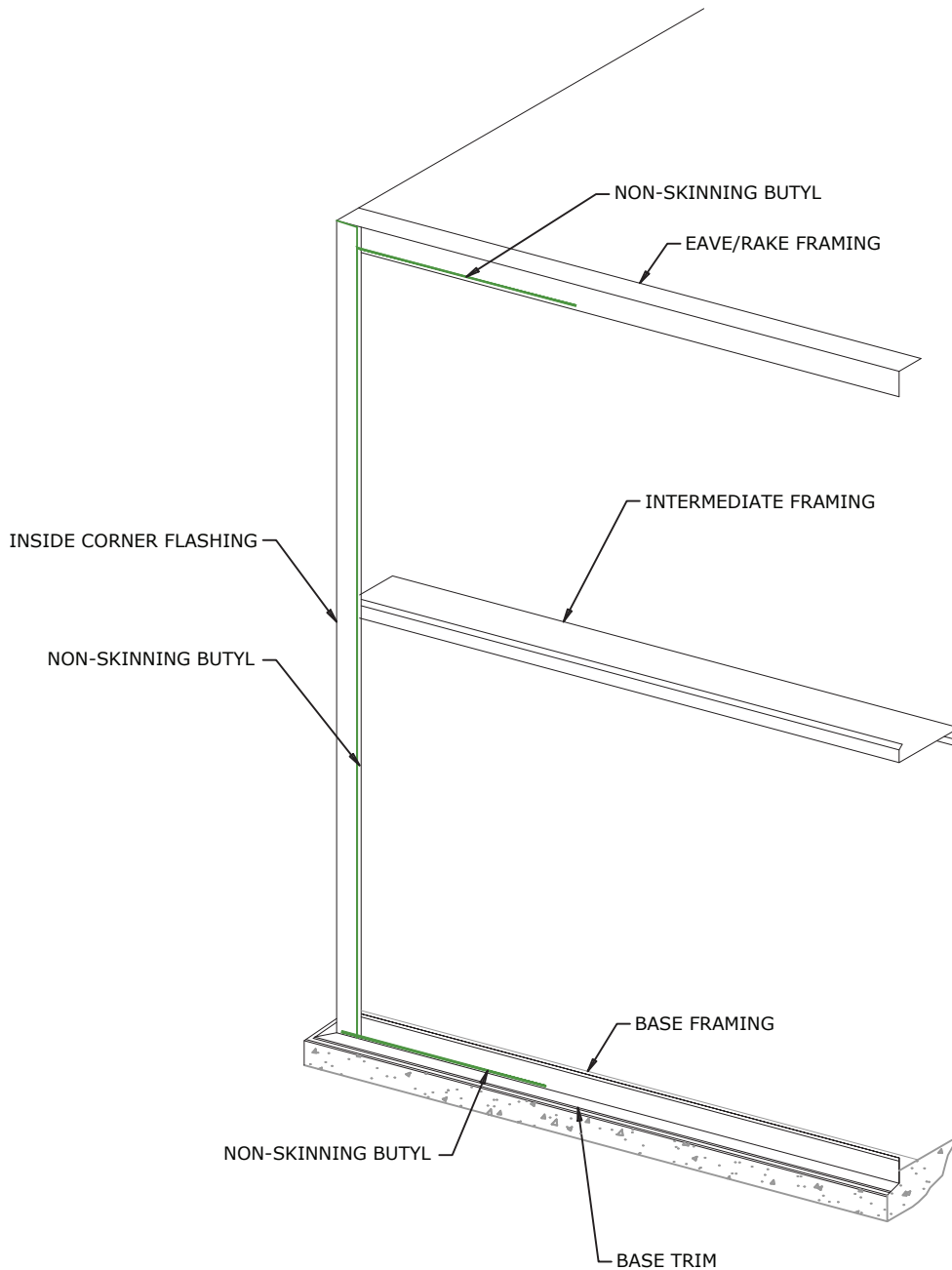

NOTES:
A. DETAILS ARE FOR GUIDELINES ONLY, AND MAY NOT BE SUITABLE FOR ALL BUILDING DESIGNS AND CONDITIONS.
B. SCREW LENGTHS MAY VARY PER CUSTOMER REQUEST.

PROFILE

IMP WALL PANELS

APPLICATION

COMMERCIAL - INDUSTRIAL

DETAIL

WALL PANEL INSTALLATION - SERIES 2

TYPE

HF-1000

DATE

MAY 1/22

REV.

A

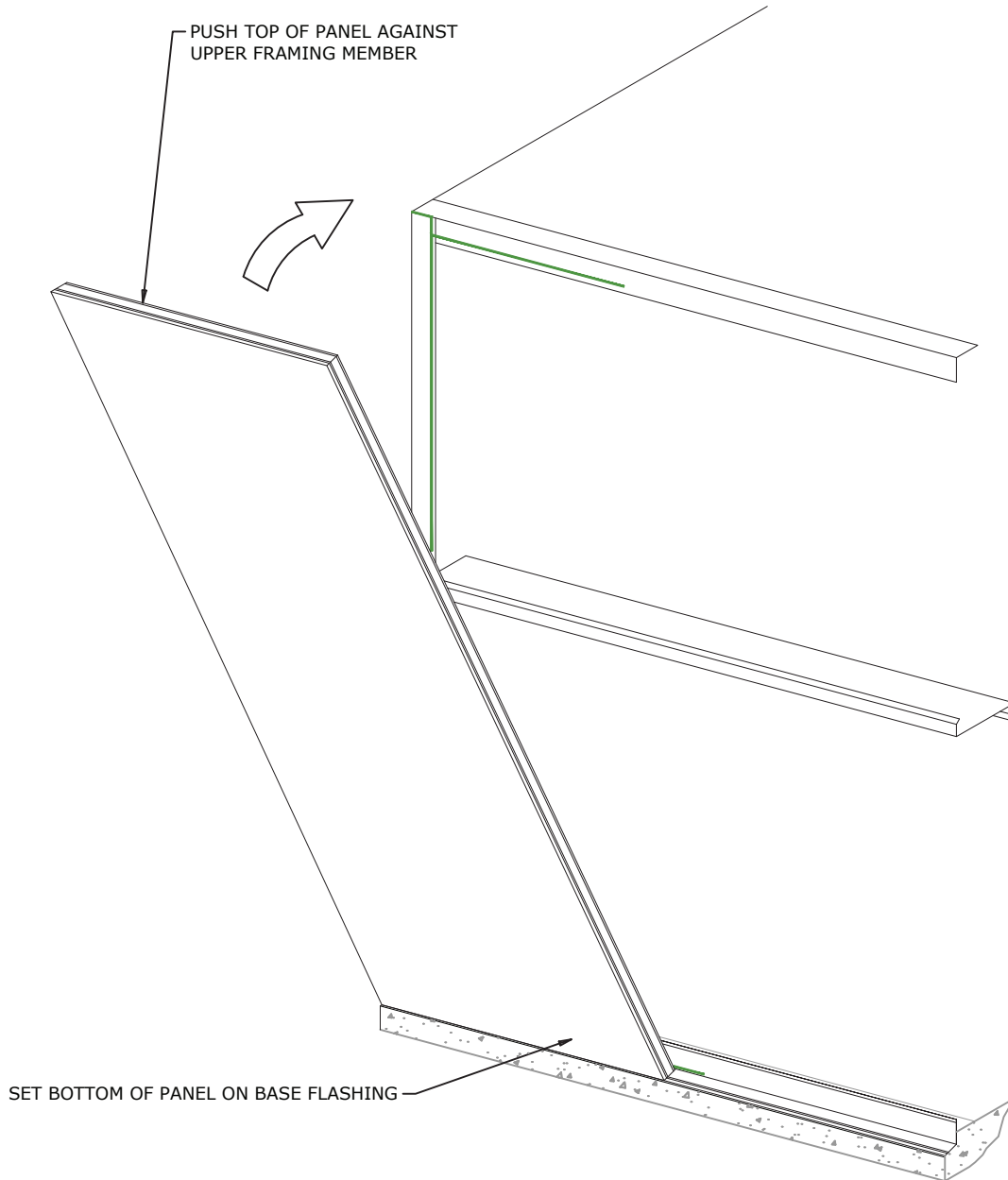

PROFILE

IMP WALL PANELS

APPLICATION

COMMERCIAL - INDUSTRIAL

DETAIL

WALL PANEL INSTALLATION - SERIES 3

TYPE

HF-1000

DATE

MAY 1/22

REV.

A

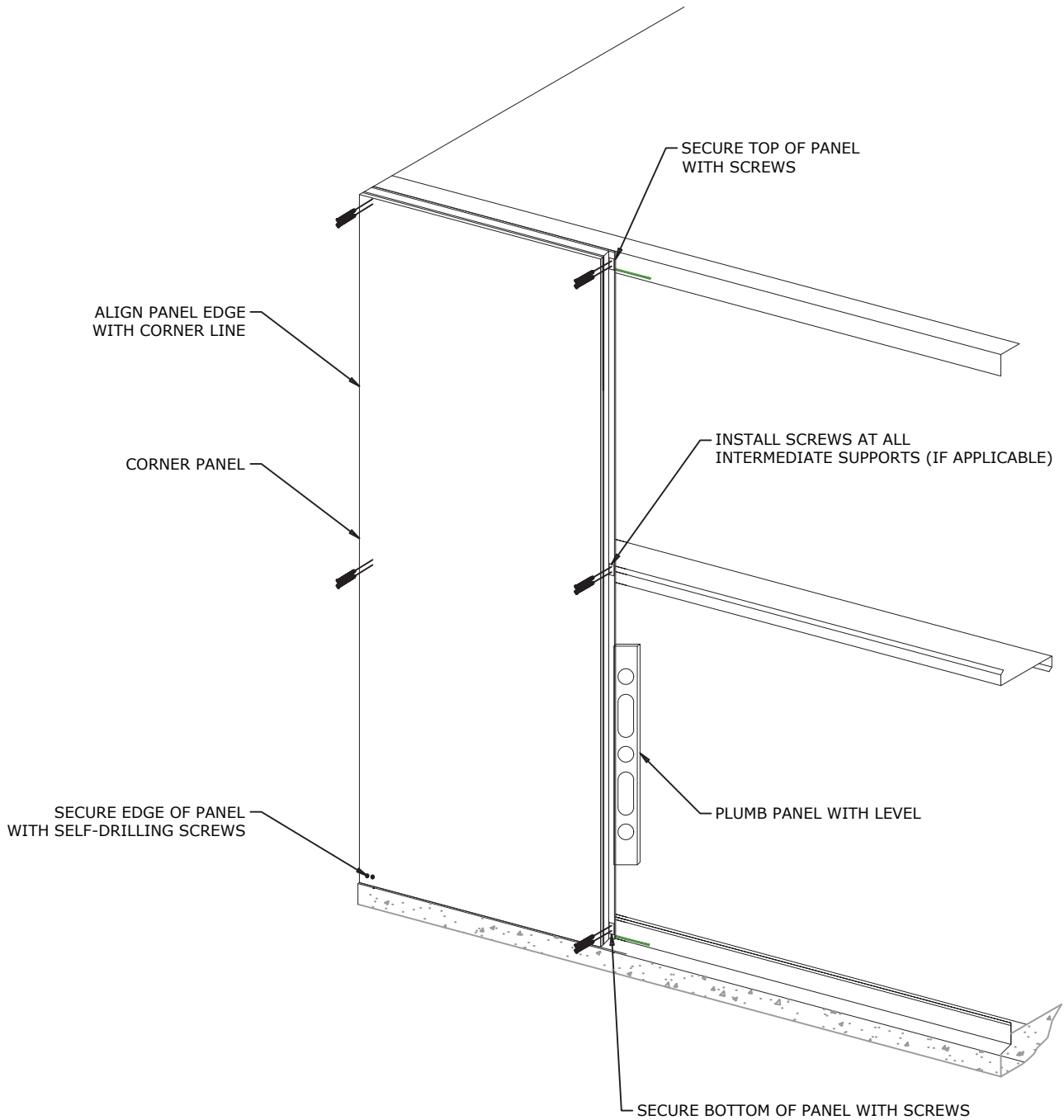

NOTES:
A. DETAILS ARE FOR GUIDELINES ONLY, AND MAY NOT BE SUITABLE FOR ALL BUILDING DESIGNS AND CONDITIONS.
B. SCREW LENGTHS MAY VARY PER CUSTOMER REQUEST.

PROFILE

IMP WALL PANELS

APPLICATION

COMMERCIAL - INDUSTRIAL

DETAIL

WALL PANEL INSTALLATION - SERIES 4

TYPE

HF-1000

DATE

MAY 1/22

REV.

A

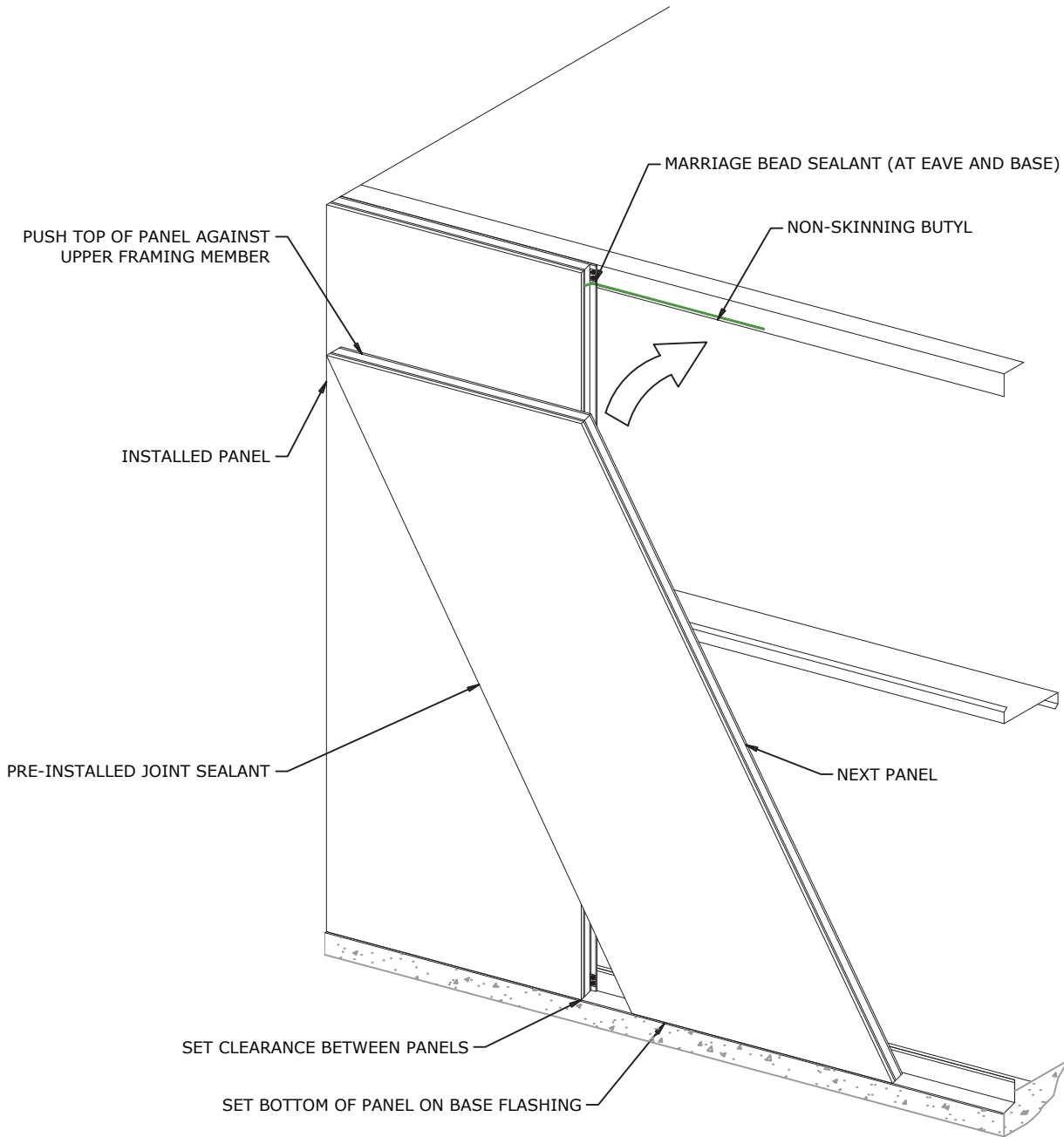

NOTES:
A. DETAILS ARE FOR GUIDELINES ONLY, AND MAY NOT BE SUITABLE FOR ALL BUILDING DESIGNS AND CONDITIONS.
B. SCREW LENGTHS MAY VARY PER CUSTOMER REQUEST.

PROFILE

IMP WALL PANELS

APPLICATION

COMMERCIAL - INDUSTRIAL

DETAIL

WALL PANEL INSTALLATION - SERIES 5

TYPE

HF-1000

DATE

MAY 1/22

REV.

A

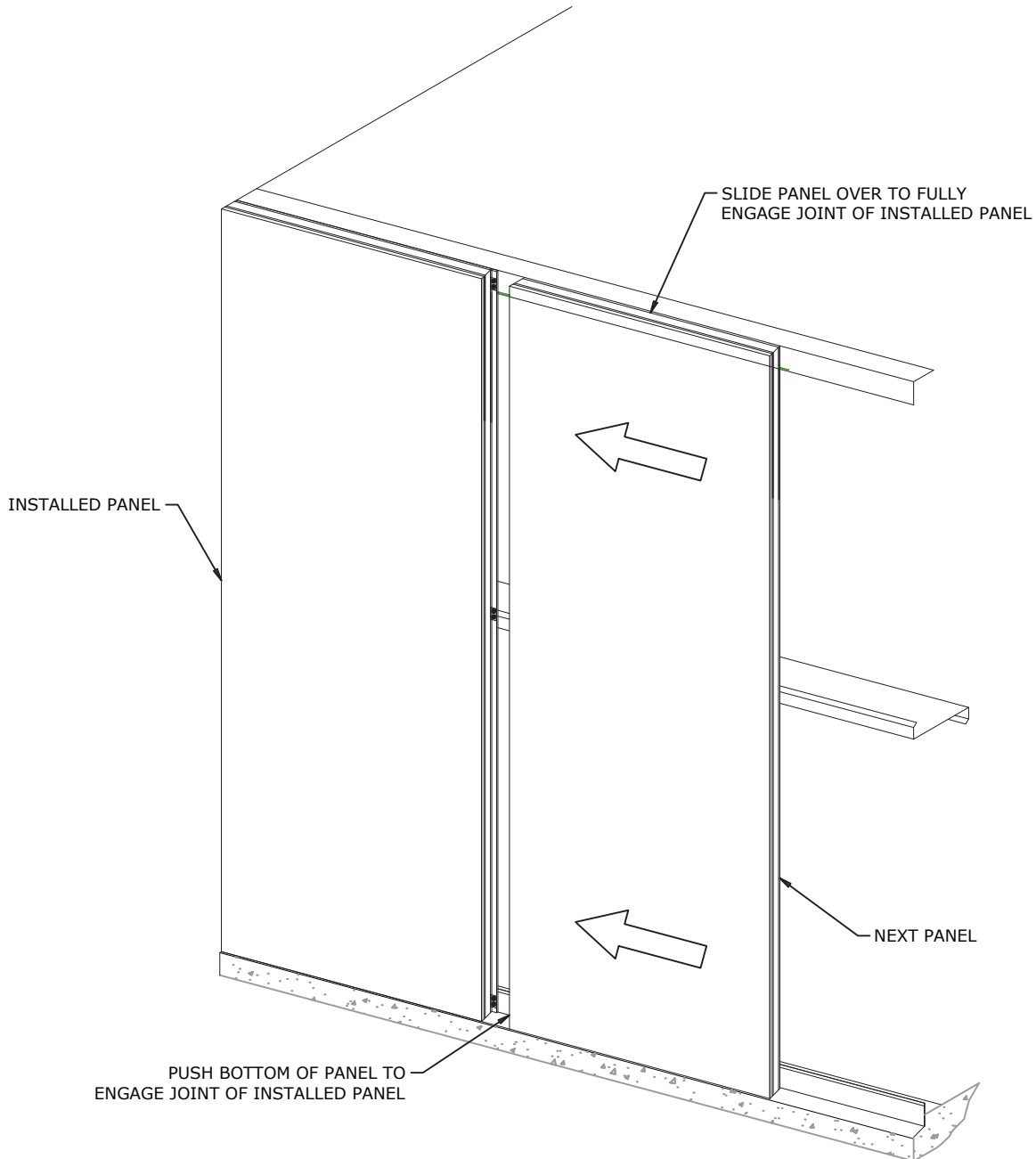

NOTES:
A. DETAILS ARE FOR GUIDELINES ONLY, AND MAY NOT BE SUITABLE FOR ALL BUILDING DESIGNS AND CONDITIONS.
B. SCREW LENGTHS MAY VARY PER CUSTOMER REQUEST.

PROFILE

IMP WALL PANELS

APPLICATION

COMMERCIAL - INDUSTRIAL

DETAIL

WALL PANEL INSTALLATION - SERIES 6

TYPE

HF-1000

DATE

MAY 1/22

REV.

A

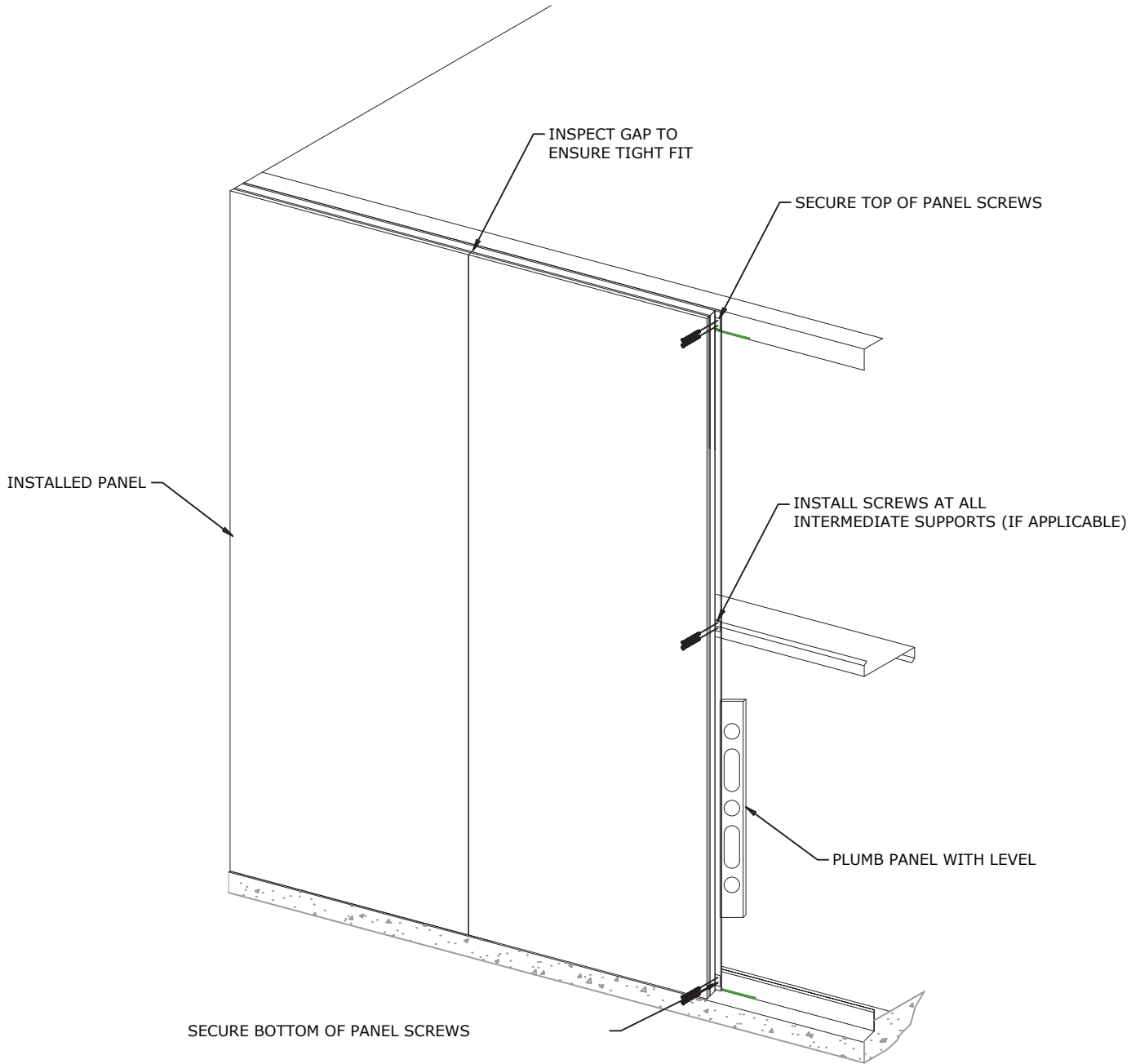

NOTES:
A. DETAILS ARE FOR GUIDELINES ONLY, AND MAY NOT BE SUITABLE FOR ALL BUILDING DESIGNS AND CONDITIONS.
B. SCREW LENGTHS MAY VARY PER CUSTOMER REQUEST.

PROFILE

IMP WALL PANELS

APPLICATION

COMMERCIAL - INDUSTRIAL

DETAIL

WALL PANEL SIDELAP

TYPE

HF-1000

DATE

MAY 1/22

REV.

A

EXTERIOR FACE
VISUALLY INSPECT PANEL JOINT TO
ENSURE SEAM IS EVENLY CLOSED WITH
AN APPROX. 1/8" (3mm) GAP

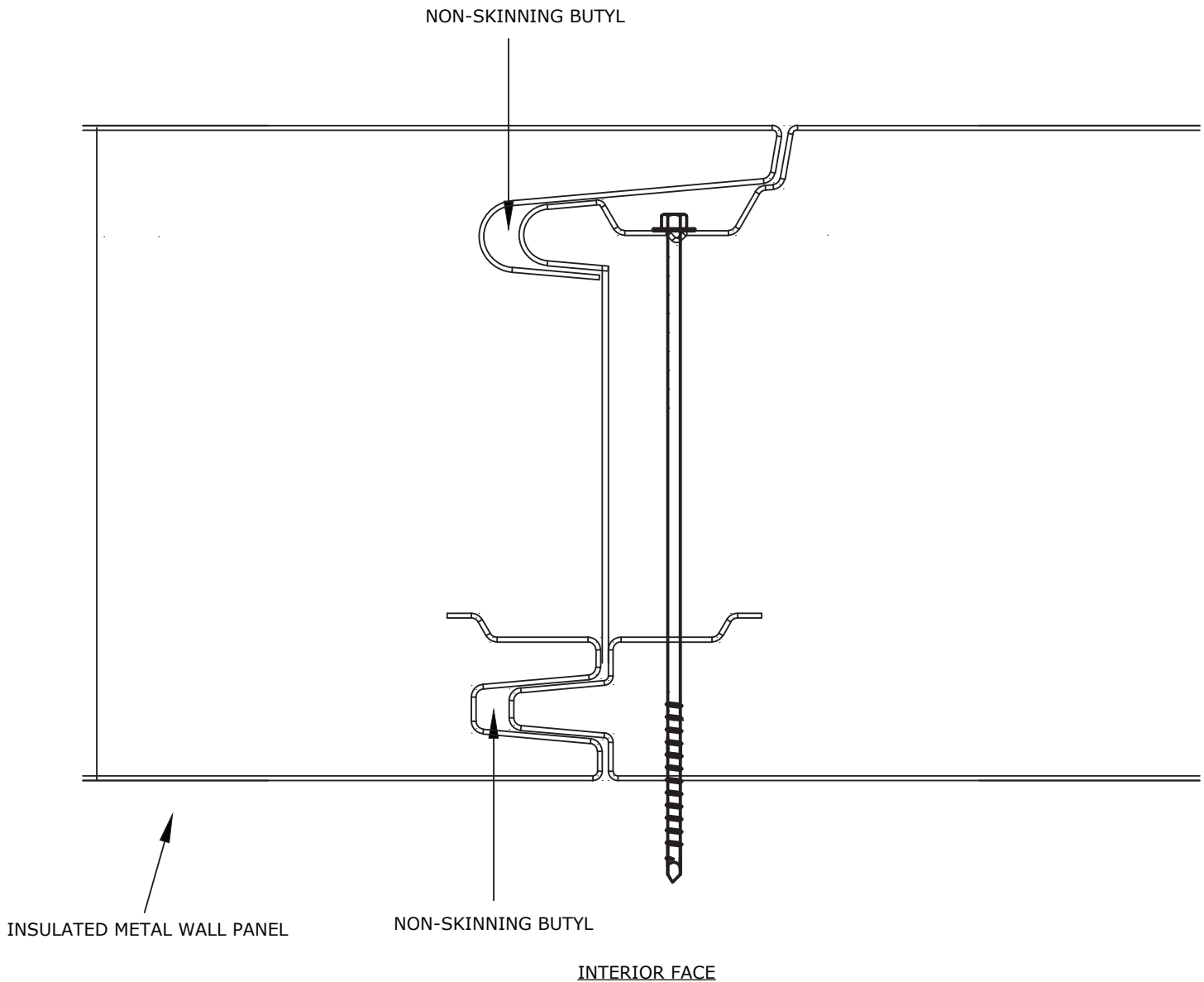

NOTES:

- AT STRUCTURAL GIRTS USE STRUCTURAL FASTENER.
- BEAD OF NON-SKINNING BUTYL IS TO BE 3/8" UNLESS NOTED OTHERWISE.
- IF SEALANT RUNS OUT OF JOIN ENSURE IT IS CLEANED OFF THE PANEL IMMEDIATELY.

- A. DETAILS ARE FOR GUIDELINES ONLY, AND MAY NOT BE SUITABLE FOR ALL BUILDING DESIGNS AND CONDITIONS.
- B. SCREW LENGTHS MAY VARY PER CUSTOMER REQUEST.

PROFILE

IMP WALL PANELS

APPLICATION

COMMERCIAL - INDUSTRIAL

DETAIL

PANEL BASE CONNECTION

TYPE

HF-1000

DATE

MAY 1/22

REV.

A

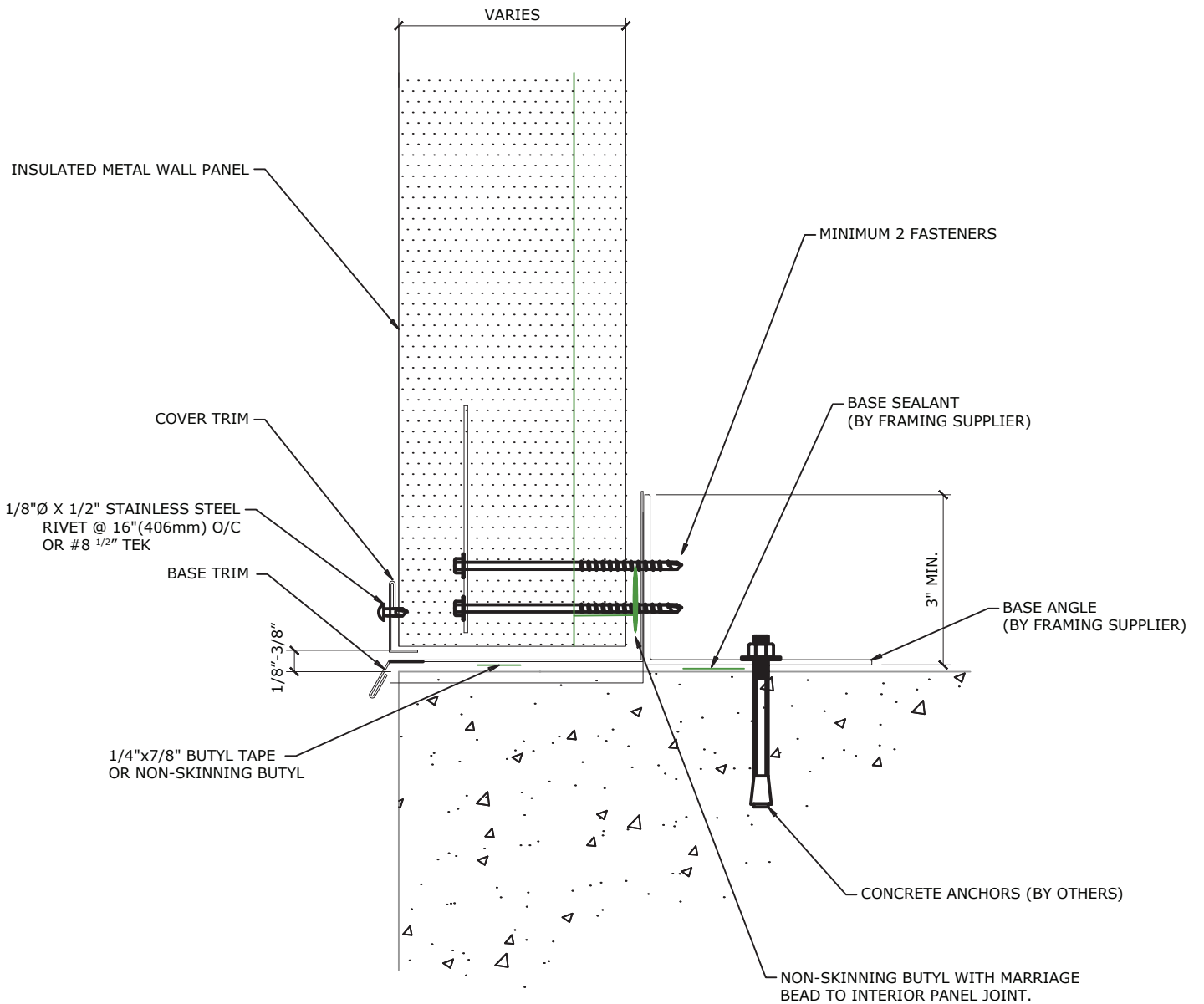

NOTES:
 A. DETAILS ARE FOR GUIDELINES ONLY, AND MAY NOT BE SUITABLE FOR ALL BUILDING DESIGNS AND CONDITIONS.
 B. SCREW LENGTHS MAY VARY PER CUSTOMER REQUEST.

PROFILE

IMP WALL PANELS

APPLICATION

COMMERCIAL - INDUSTRIAL

DETAIL

PANEL BASE CONNECTION W/ INSULATION

TYPE

HF-1000

DATE

MAY 1/22

REV.

A

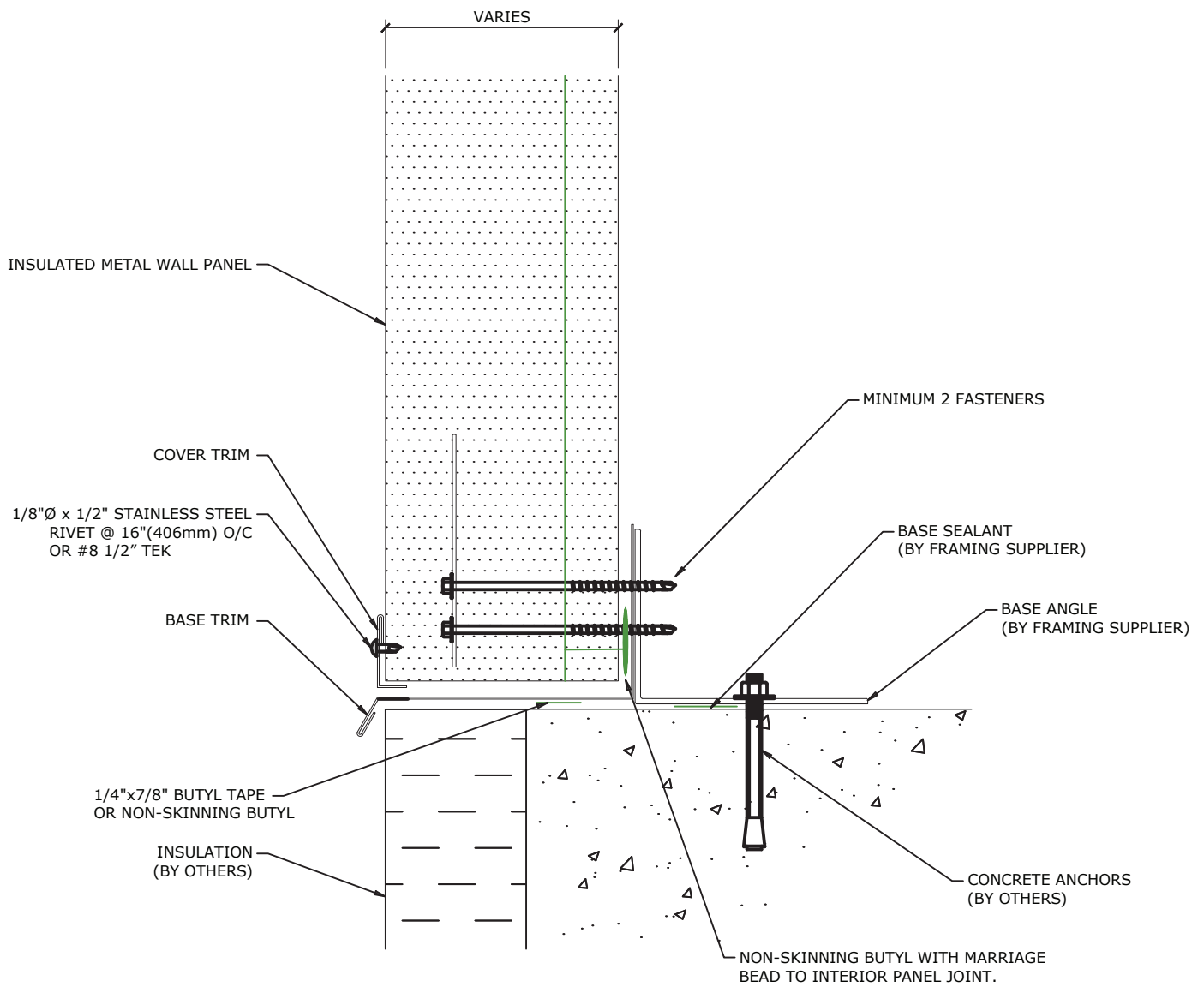

NOTES:
 A. DETAILS ARE FOR GUIDELINES ONLY, AND MAY NOT BE SUITABLE FOR ALL BUILDING DESIGNS AND CONDITIONS.
 B. SCREW LENGTHS MAY VARY PER CUSTOMER REQUEST.

PROFILE
IMP WALL PANELS

DETAIL
OUTSIDE CORNER

APPLICATION
COMMERCIAL - INDUSTRIAL

TYPE
HF-1000

DATE
MAY 1/22

REV.
A

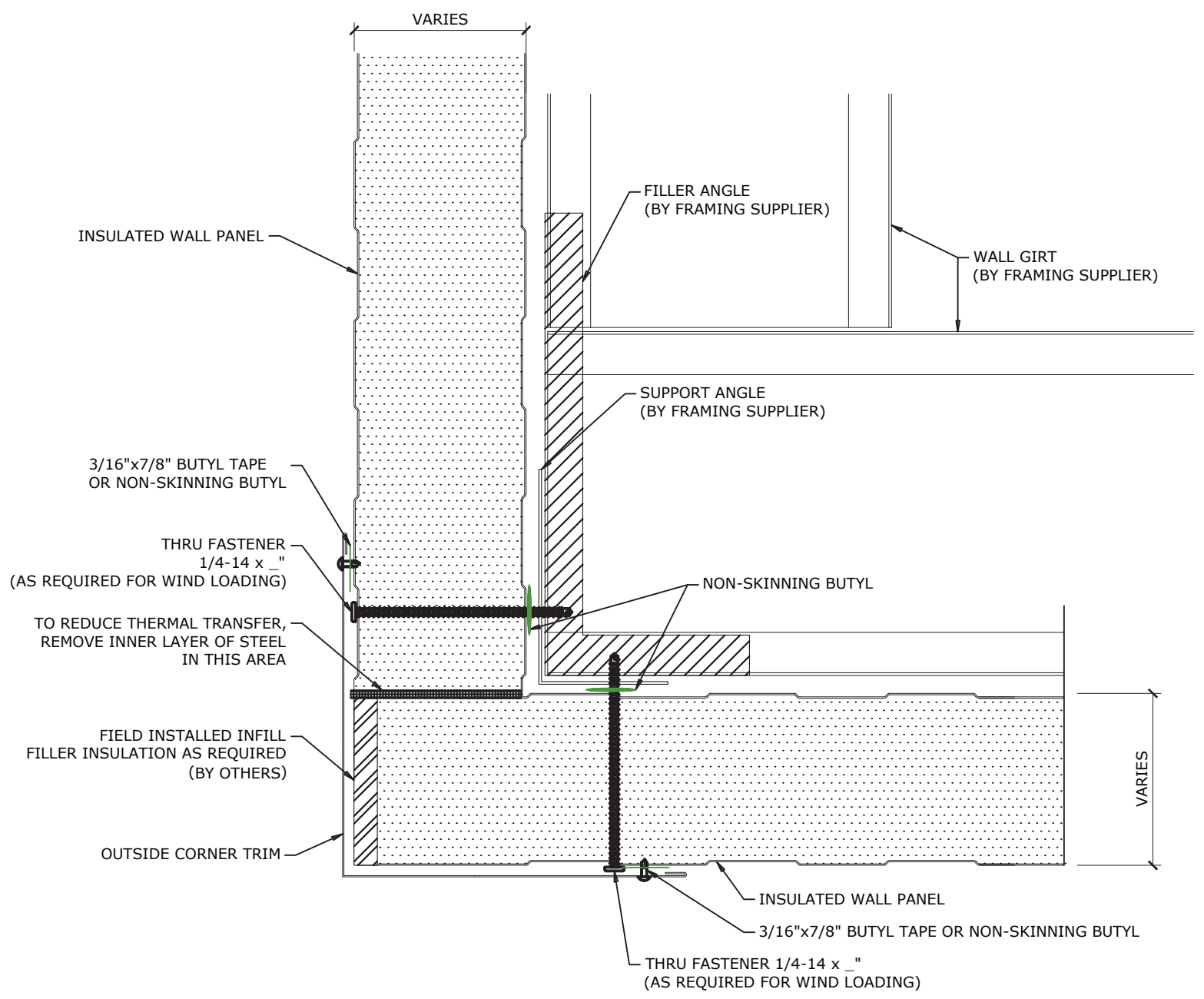

NOTE:
 - FIELD CUT STARTING PANEL AND ENDING PANEL AS REQUIRED AT CORNER TRANSITION.
 - SEALER IN THE OUTER GROOVE OF THE WALL PANEL AND BEHIND THE OUTER TRIMS IS ONLY REQUIRED IN WET LOCATIONS AND WHERE A REVERSE VAPOUR BARRIER IS REQUIRED.
 SEE BUILDING SPECIFIC DRAWINGS.

NOTES:
 A. DETAILS ARE FOR GUIDELINES ONLY, AND MAY NOT BE SUITABLE FOR ALL BUILDING DESIGNS AND CONDITIONS.
 B. SCREW LENGTHS MAY VARY PER CUSTOMER REQUEST.

PROFILE

IMP WALL PANELS

APPLICATION

COMMERCIAL - INDUSTRIAL

DETAIL

OUTSIDE CORNER

TYPE

HF-1000

DATE

MAY 1/22

REV.

A

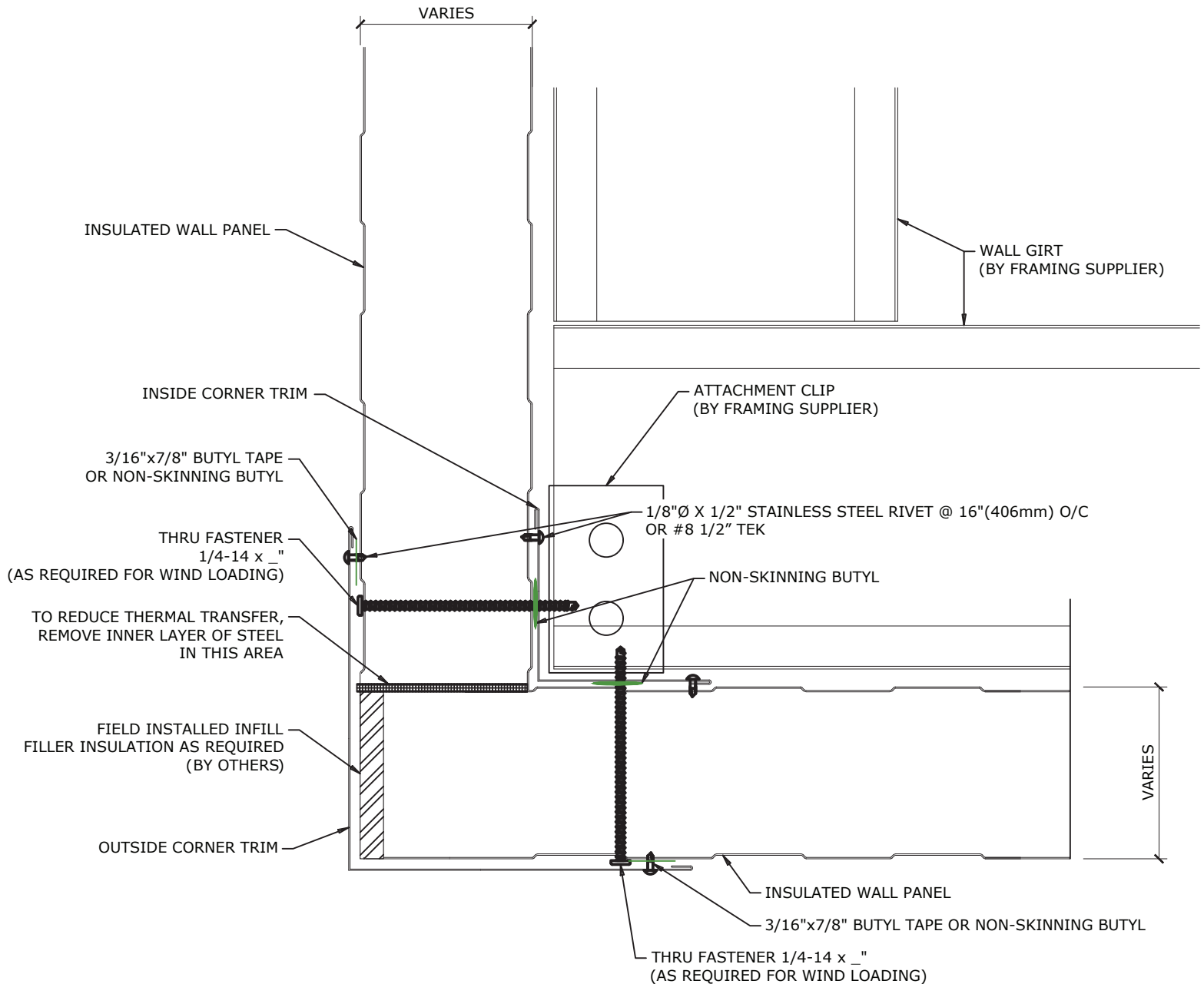

NOTE:

- FIELD CUT STARTING PANEL AND ENDING PANEL AS REQUIRED AT CORNER TRANSITION.
- SEALER IN THE OUTER GROOVE OF THE WALL PANEL AND BEHIND THE OUTER TRIMS IS ONLY REQUIRED IN WET LOCATIONS AND WHERE A REVERSE VAPOUR BARRIER IS REQUIRED.
- SEE BUILDING SPECIFIC DRAWINGS.

NOTES:

- A. DETAILS ARE FOR GUIDELINES ONLY, AND MAY NOT BE SUITABLE FOR ALL BUILDING DESIGNS AND CONDITIONS.
- B. SCREW LENGTHS MAY VARY PER CUSTOMER REQUEST.

PROFILE

IMP WALL PANELS

APPLICATION

COMMERCIAL - INDUSTRIAL

DETAIL

INSIDE CORNER

TYPE

HF-1000

DATE

MAY 1/22

REV.

A

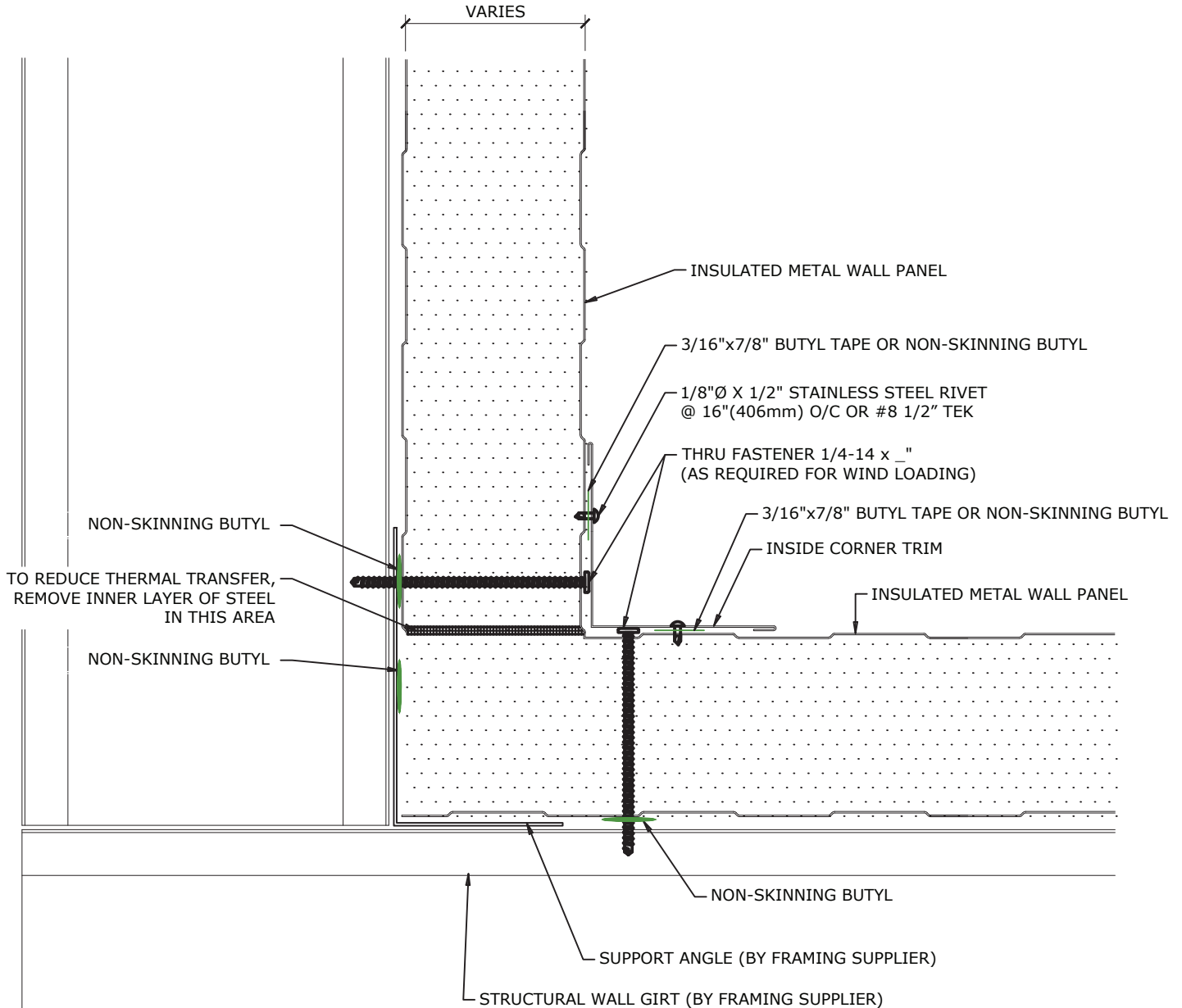

NOTE:

- BEAD OF NON-SKINNING BUTYL [SL05] IS TO BE 3/8" UNLESS NOTED OTHERWISE.
- IF SEALANT RUNS OUT OF JOINT ENSURE IT IS CLEANED OFF THE PANEL IMMEDIATELY.
- FIELD CUT STARTING PANEL AND ENDING PANEL AS REQUIRED AT CORNER TRANSITION.
- SEALER IN THE OUTER GROOVE OF THE WALL PANEL AND BEHIND THE OUTER TRIMS IS ONLY REQUIRED IN WET LOCATIONS WHERE A REVERSE VAPOUR BARRIER IS REQUIRED. SEE BUILDING SPECIFIC DRAWINGS.

NOTES:

- A. DETAILS ARE FOR GUIDELINES ONLY, AND MAY NOT BE SUITABLE FOR ALL BUILDING DESIGNS AND CONDITIONS.
- B. SCREW LENGTHS MAY VARY PER CUSTOMER REQUEST.

PROFILE

IMP WALL PANELS

APPLICATION

COMMERCIAL - INDUSTRIAL

DETAIL

INSIDE CORNER

TYPE

HF-1000

DATE

MAY 1/22

REV.

A

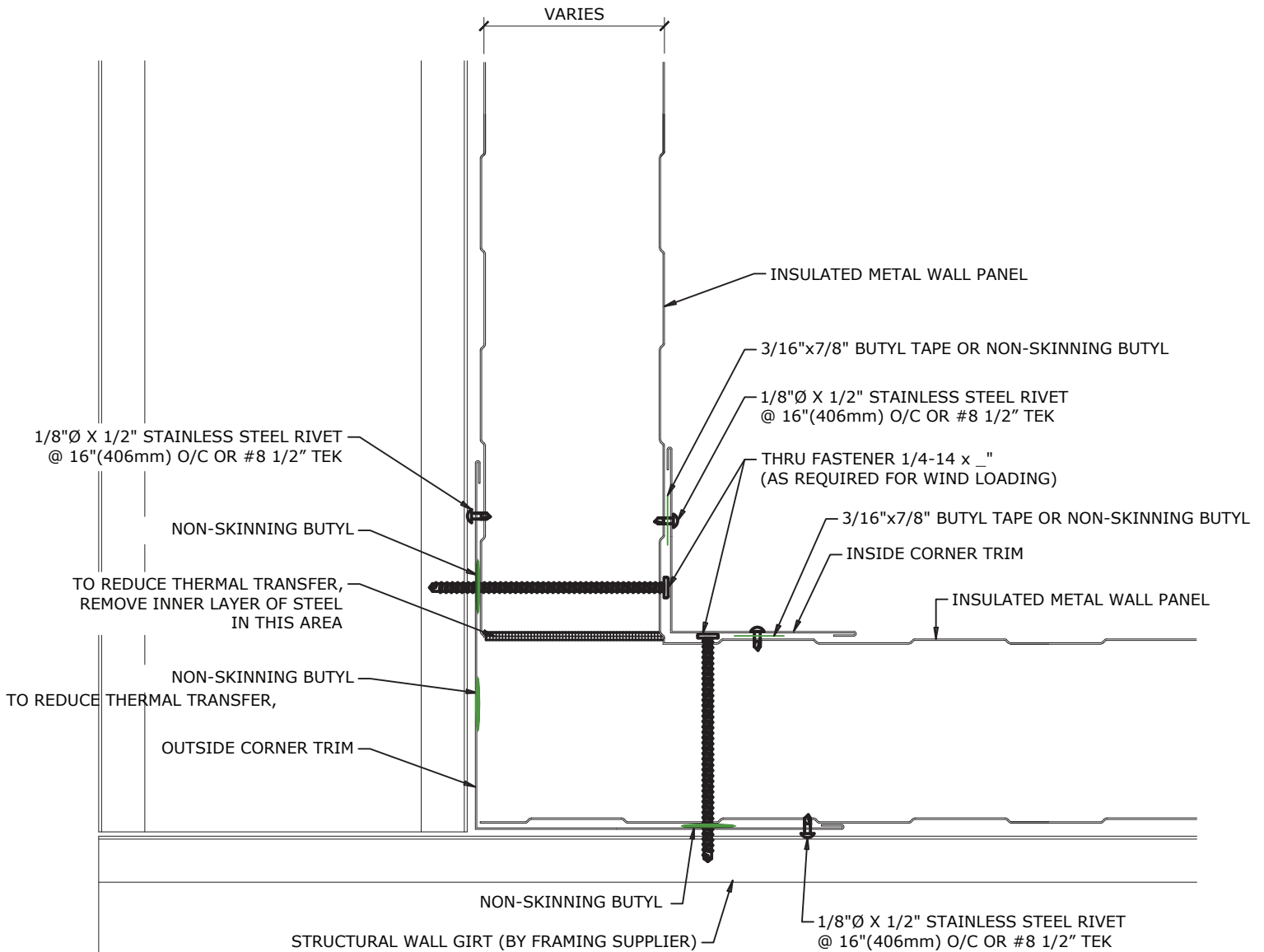

NOTE:

- BEAD OF NON-SKINNING BUTYL IS TO BE 3/8" UNLESS NOTED OTHERWISE.
- IF SEALANT RUNS OUT OF JOINT ENSURE IT IS CLEANED OFF THE PANEL IMMEDIATELY.
- FIELD CUT STARTING PANEL AND ENDING PANEL AS REQUIRED AT CORNER TRANSITION.
- SEALER IN THE OUTER GROOVE OF THE WALL PANEL AND BEHIND THE OUTER TRIMS IS ONLY REQUIRED IN WET LOCATIONS WHERE A REVERSE VAPOUR BARRIER IS REQUIRED. SEE BUILDING SPECIFIC DRAWINGS.

NOTES:

- A. DETAILS ARE FOR GUIDELINES ONLY, AND MAY NOT BE SUITABLE FOR ALL BUILDING DESIGNS AND CONDITIONS.
- B. SCREW LENGTHS MAY VARY PER CUSTOMER REQUEST.

PROFILE

IMP WALL PANELS

APPLICATION

COMMERCIAL - INDUSTRIAL

DETAIL

DOOR HEADER

TYPE

HF-1000

DATE

MAY 1/22

REV.

A

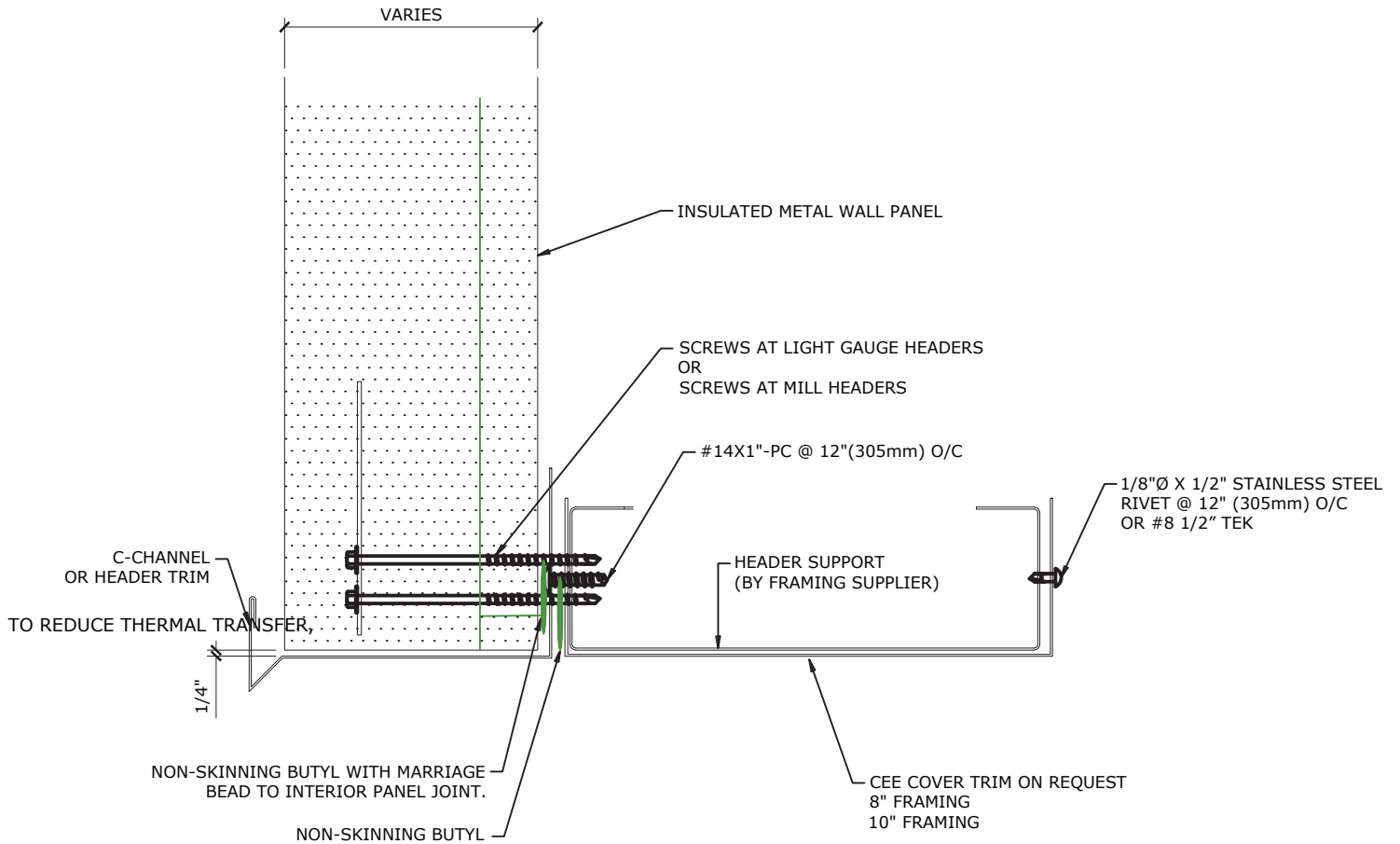

NOTE:

- BEAD OF NON-SKINNING BUTYL IS TO BE 3/8" UNLESS NOTED OTHERWISE.
- IF SEALANT RUNS OUT OF JOINT ENSURE IT IS CLEANED OFF THE PANEL IMMEDIATELY.
- BEAD OF URETHANE POLYSEAL IS TO BE 1/4" MINIMUM. A LARGER BEAD MAY BE USED IF REQUIRED.

NOTES:

- A. DETAILS ARE FOR GUIDELINES ONLY, AND MAY NOT BE SUITABLE FOR ALL BUILDING DESIGNS AND CONDITIONS.
- B. SCREW LENGTHS MAY VARY PER CUSTOMER REQUEST.

PROFILE

IMP WALL PANELS

APPLICATION

COMMERCIAL - INDUSTRIAL

DETAIL

DOOR JAMB

TYPE

HF-1000

DATE

MAY 1/22

REV.

A

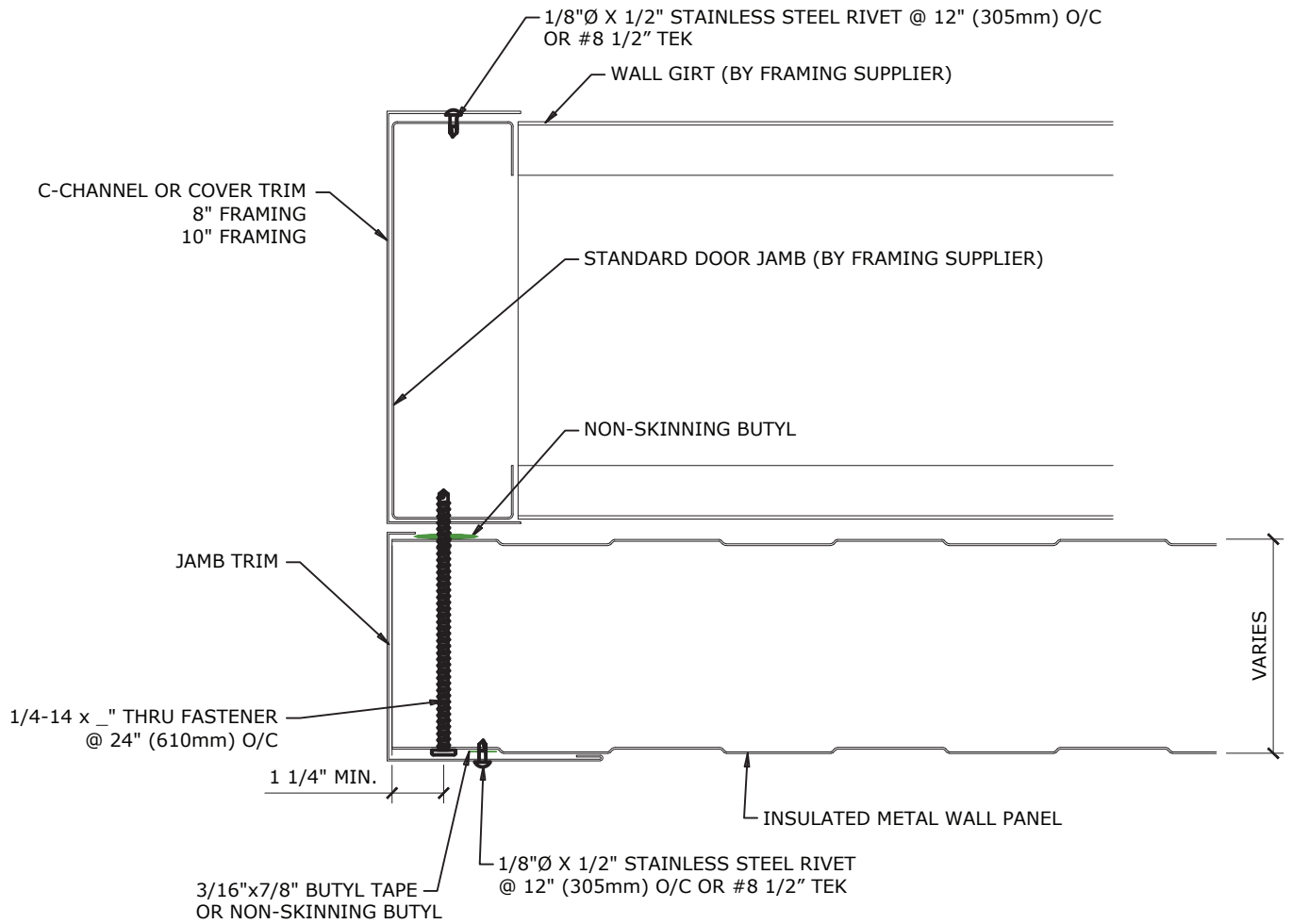

NOTE:

- BEAD OF NON-SKINNING BUTYL IS TO BE 3/8" UNLESS NOTED OTHERWISE.
- IF SEALANT RUNS OUT OF JOINT ENSURE IT IS CLEANED OFF THE PANEL IMMEDIATELY.
- BEAD OF URETHANE POLYSEAL IS TO BE 1/4" MINIMUM. A LARGER BEAD MAY BE USED IF REQUIRED.

NOTES:

- A. DETAILS ARE FOR GUIDELINES ONLY, AND MAY NOT BE SUITABLE FOR ALL BUILDING DESIGNS AND CONDITIONS.
- B. SCREW LENGTHS MAY VARY PER CUSTOMER REQUEST.

PROFILE

IMP WALL PANELS

APPLICATION

COMMERCIAL - INDUSTRIAL

DETAIL

WINDOW HEADER

TYPE

HF-1000

DATE

MAY 1/22

REV.

A

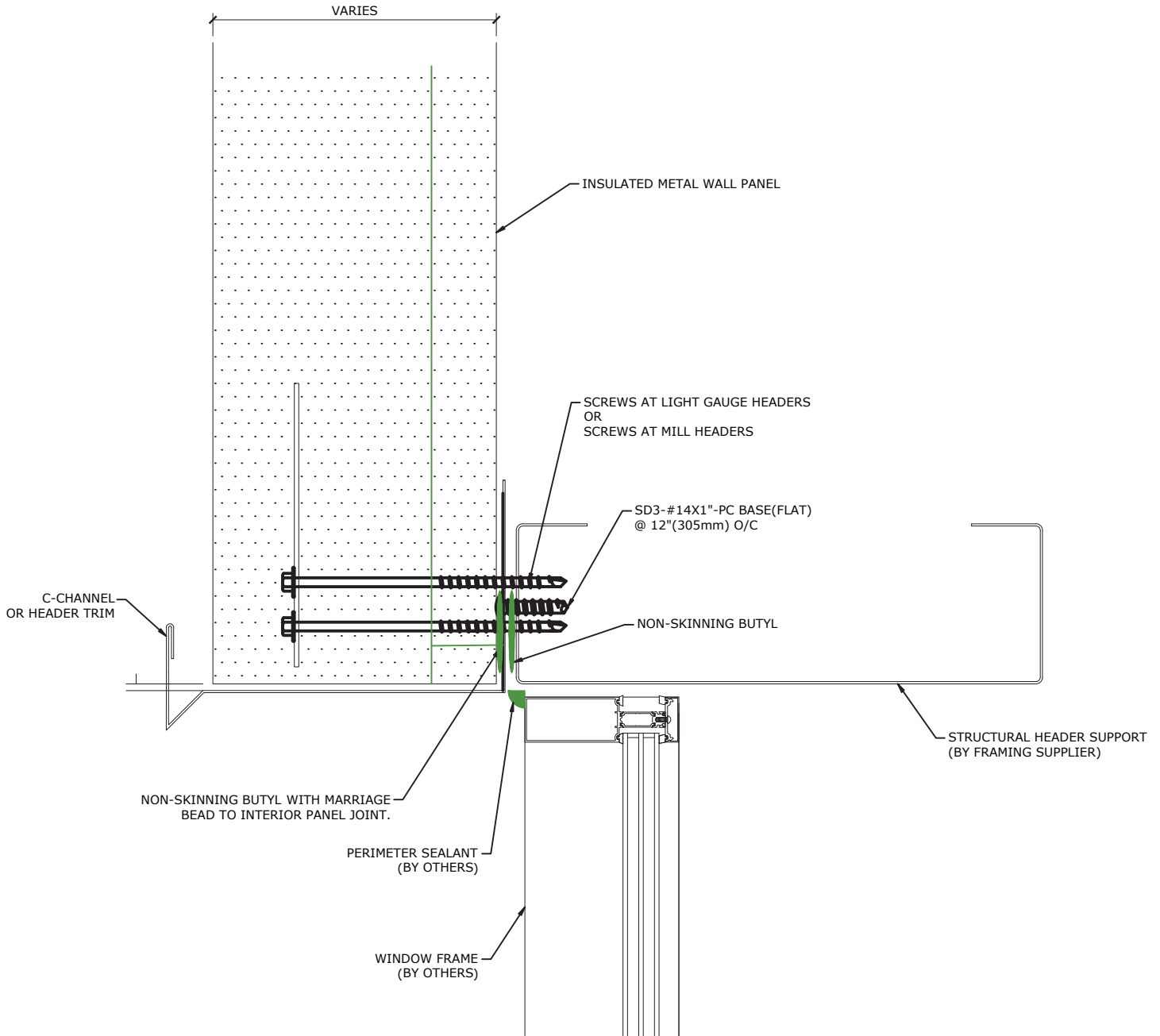

NOTE:

- BEAD OF NON-SKINNING BUTYL IS TO BE 3/8" UNLESS NOTED OTHERWISE.
- IF SEALANT RUNS OUT OF JOINT ENSURE IT IS CLEANED OFF THE PANEL IMMEDIATELY.
- BEAD OF URETHANE POLYSEAL IS TO BE 1/4" MINIMUM. A LARGER BEAD MAY BE USED IF REQUIRED.

NOTES:

- A. DETAILS ARE FOR GUIDELINES ONLY, AND MAY NOT BE SUITABLE FOR ALL BUILDING DESIGNS AND CONDITIONS.
- B. SCREW LENGTHS MAY VARY PER CUSTOMER REQUEST.

PROFILE

IMP WALL PANELS

APPLICATION

COMMERCIAL - INDUSTRIAL

DETAIL

WINDOW JAMB

TYPE

HF-1000

DATE

MAY 1/22

REV.

A

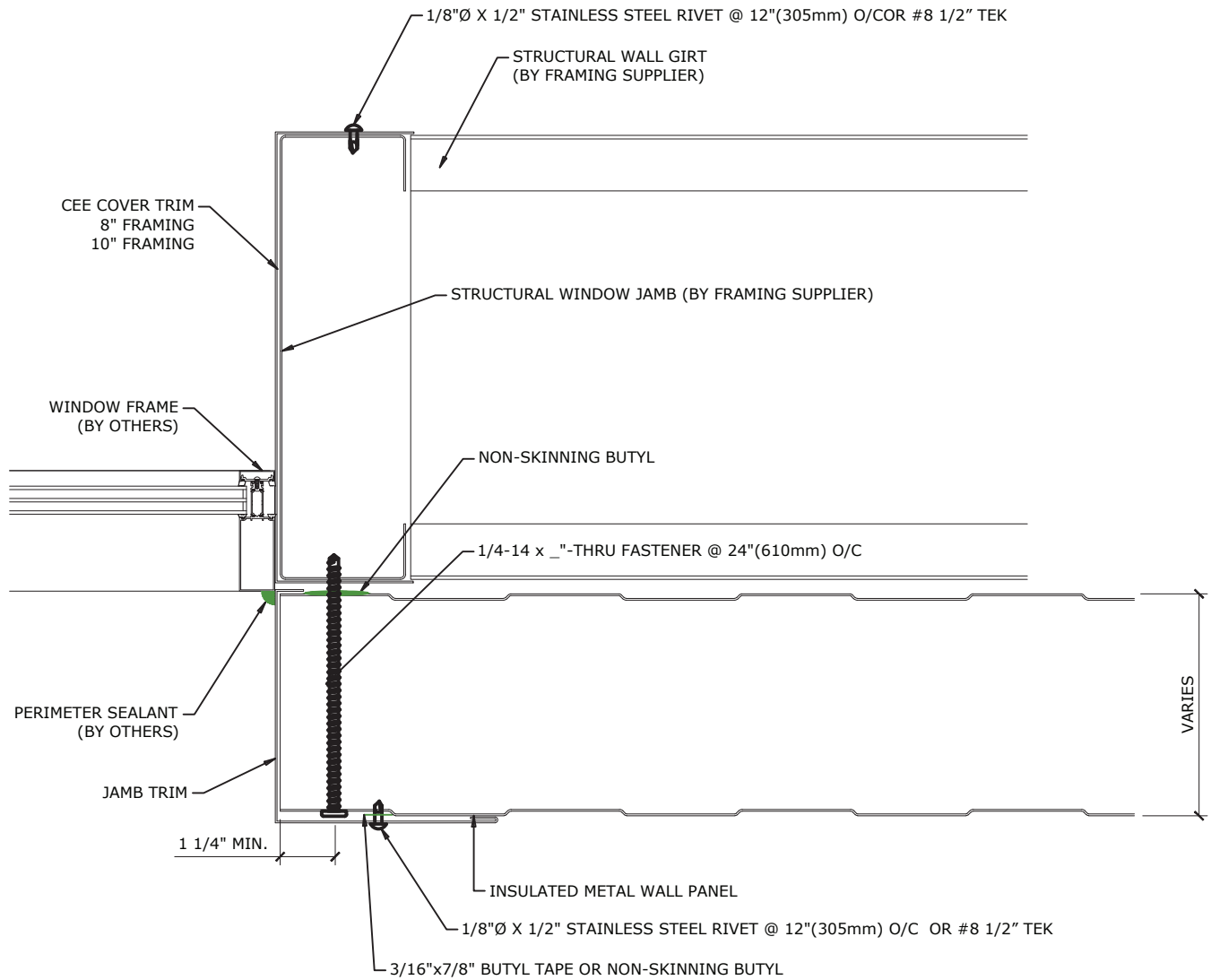

NOTE:

- BEAD OF NON-SKINNING BUTYL IS TO BE 3/8" UNLESS NOTED OTHERWISE.
- IF SEALANT RUNS OUT OF JOINT ENSURE IT IS CLEANED OFF THE PANEL IMMEDIATELY.
- BEAD OF URETHANE POLYSEAL IS TO BE 1/4" MINIMUM. A LARGER BEAD MAY BE USED IF REQUIRED.

NOTES:

- A. DETAILS ARE FOR GUIDELINES ONLY, AND MAY NOT BE SUITABLE FOR ALL BUILDING DESIGNS AND CONDITIONS.
- B. SCREW LENGTHS MAY VARY PER CUSTOMER REQUEST.

PROFILE

IMP WALL PANELS

APPLICATION

COMMERCIAL - INDUSTRIAL

DETAIL

WINDOW SILL

TYPE

HF-1000

DATE

MAY 1/22

REV.

A

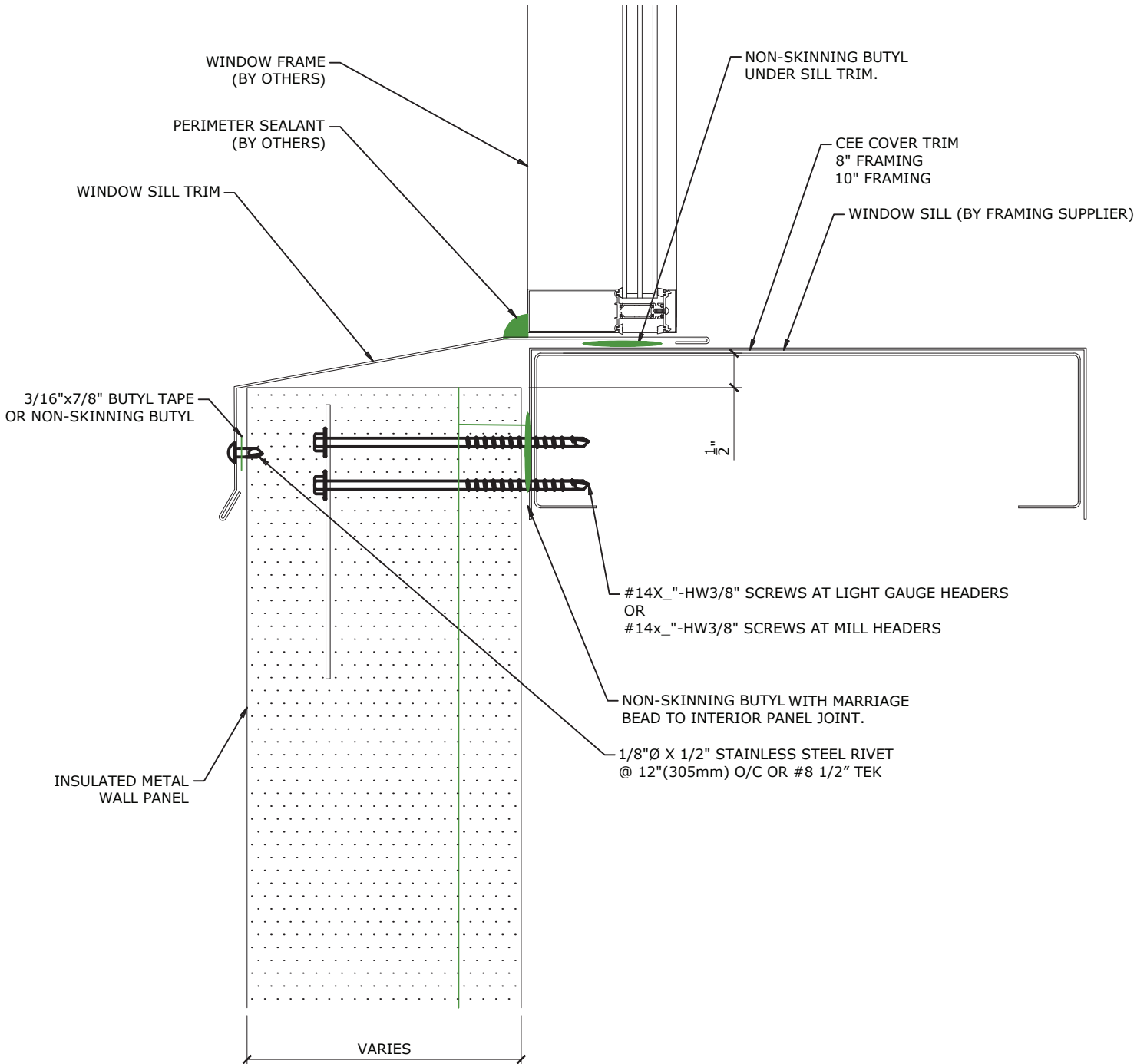

NOTES:
 A. DETAILS ARE FOR GUIDELINES ONLY, AND MAY NOT BE SUITABLE FOR ALL BUILDING DESIGNS AND CONDITIONS.
 B. SCREW LENGTHS MAY VARY PER CUSTOMER REQUEST.

PROFILE

IMP WALL PANELS

APPLICATION

COMMERCIAL - INDUSTRIAL

DETAIL

VERTICAL STACK JOINT

TYPE

HF-1000

DATE

MAY 1/22

REV.

A

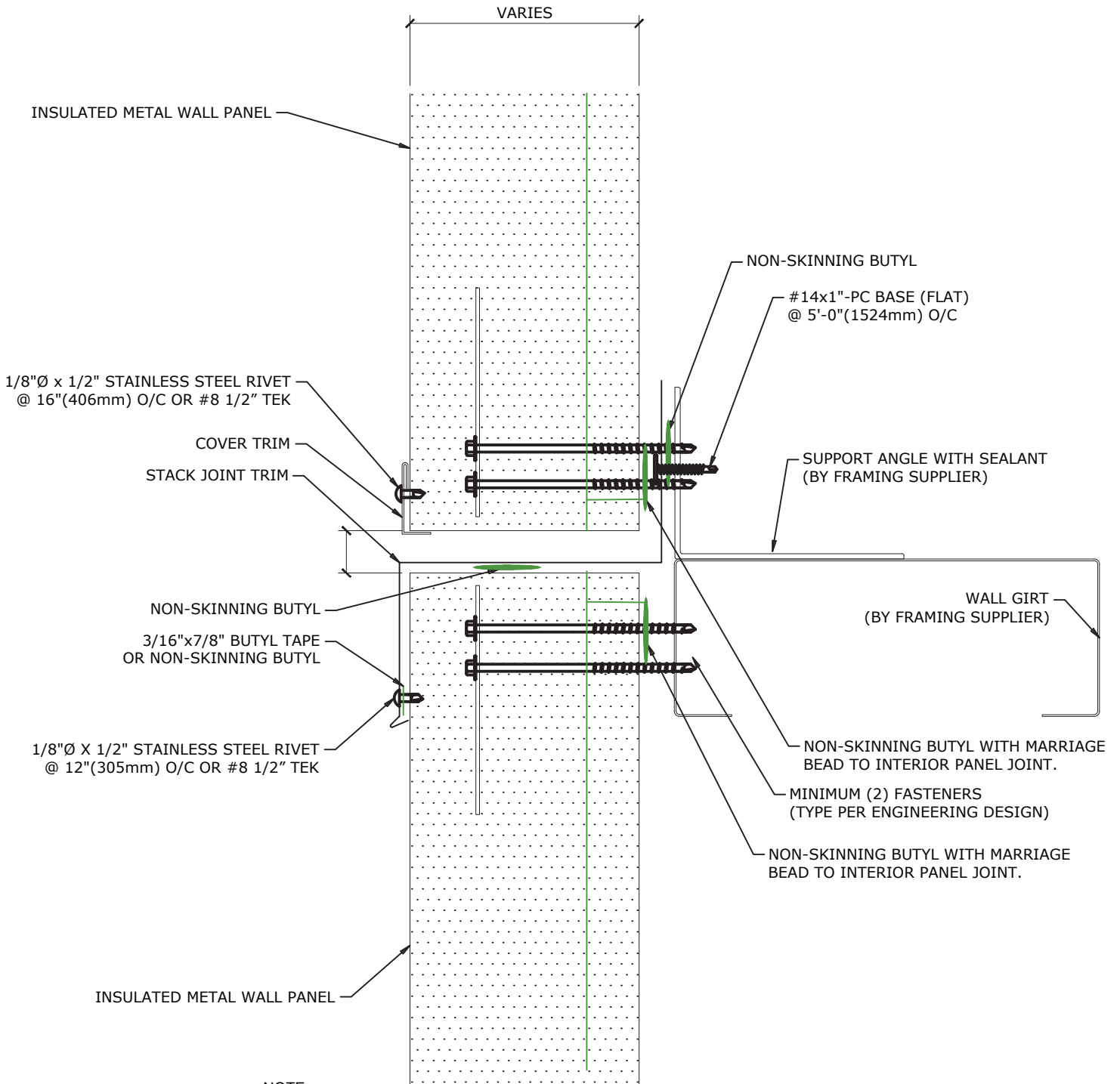

NOTE:

- BEAD OF NON-SKINNING BUTYL IS TO BE 3/8" UNLESS NOTED OTHERWISE.
- IF SEALANT RUNS OUT OF JOINT ENSURE IT IS CLEANED OFF THE PANEL IMMEDIATELY.
- BEAD OF URETHANE POLYSEAL IS TO BE 1/4" MINIMUM. A LARGER BEAD MAY BE USED IF REQUIRED.

NOTES:

- A. DETAILS ARE FOR GUIDELINES ONLY, AND MAY NOT BE SUITABLE FOR ALL BUILDING DESIGNS AND CONDITIONS.
- B. SCREW LENGTHS MAY VARY PER CUSTOMER REQUEST.

1. Make a mark on gable wall at the same height as the truss peak and snap the line to the top of the eave wall as shown below.

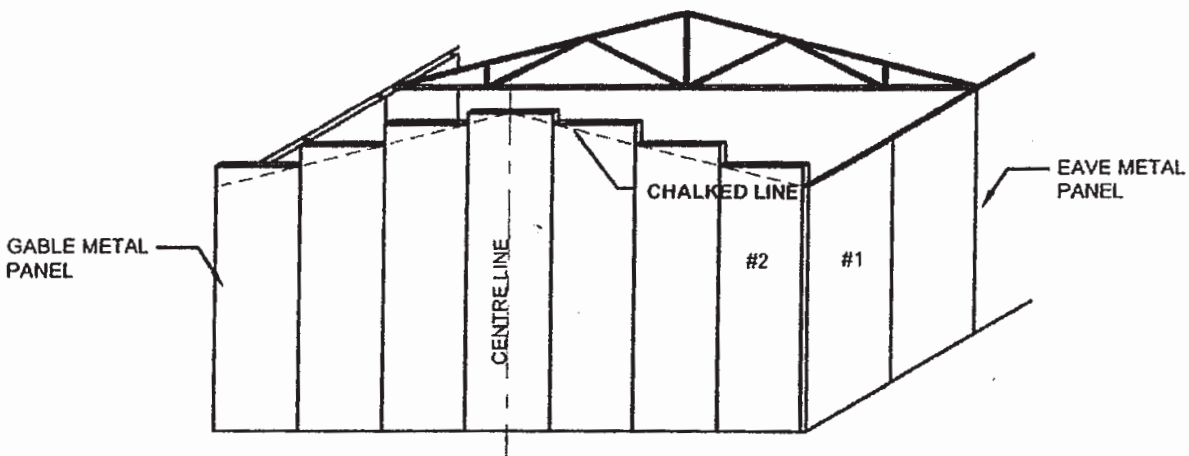

2. Cut along chalk line with circular saw, then install top cap channel (Gable cap). Do this on both ends, once this is completed, the building is ready for roof installation.

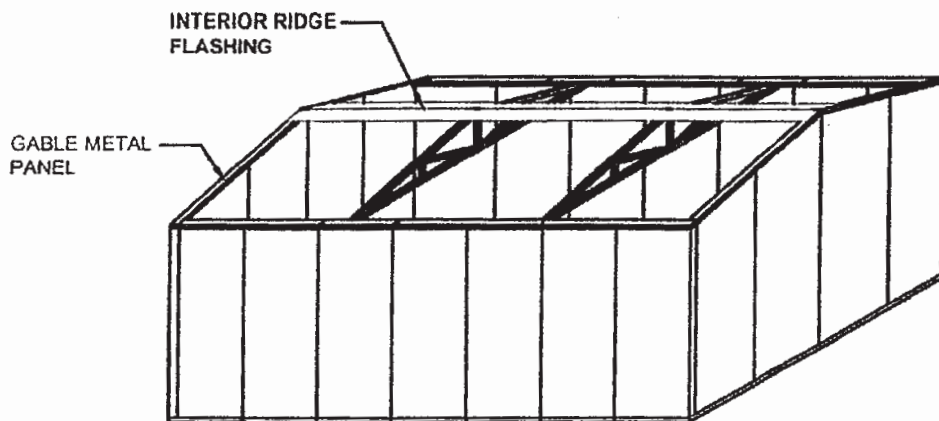

PROFILE

TYPICAL INSTALLATION WALL METAL PANEL

APPLICATION

COMMERCIAL - INDUSTRIAL

TYPE

HF-1000

DATE

MAY 1/22

REV.

A

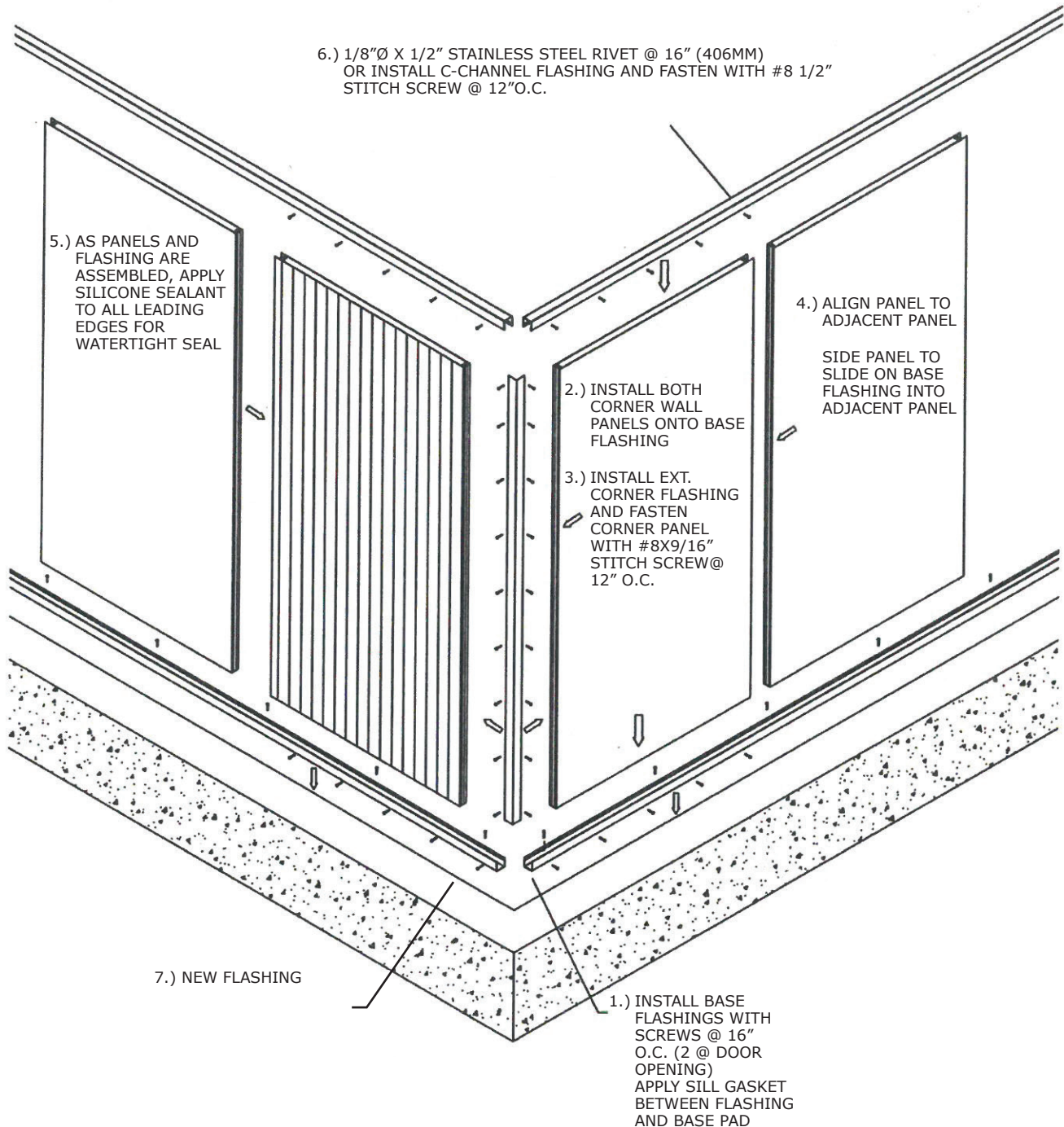

NOTES:

- A. DETAILS ARE FOR GUIDELINES ONLY, AND MAY NOT BE SUITABLE FOR ALL BUILDING DESIGNS AND CONDITIONS.
- B. SCREW LENGTHS MAY VARY PER CUSTOMER REQUEST.

PROFILE

IMP WALL PANELS

APPLICATION

COMMERCIAL - INDUSTRIAL

DETAIL

TRIM END LAP - BASE

TYPE

HF-1000

DATE

MAY 1/22

REV.

A

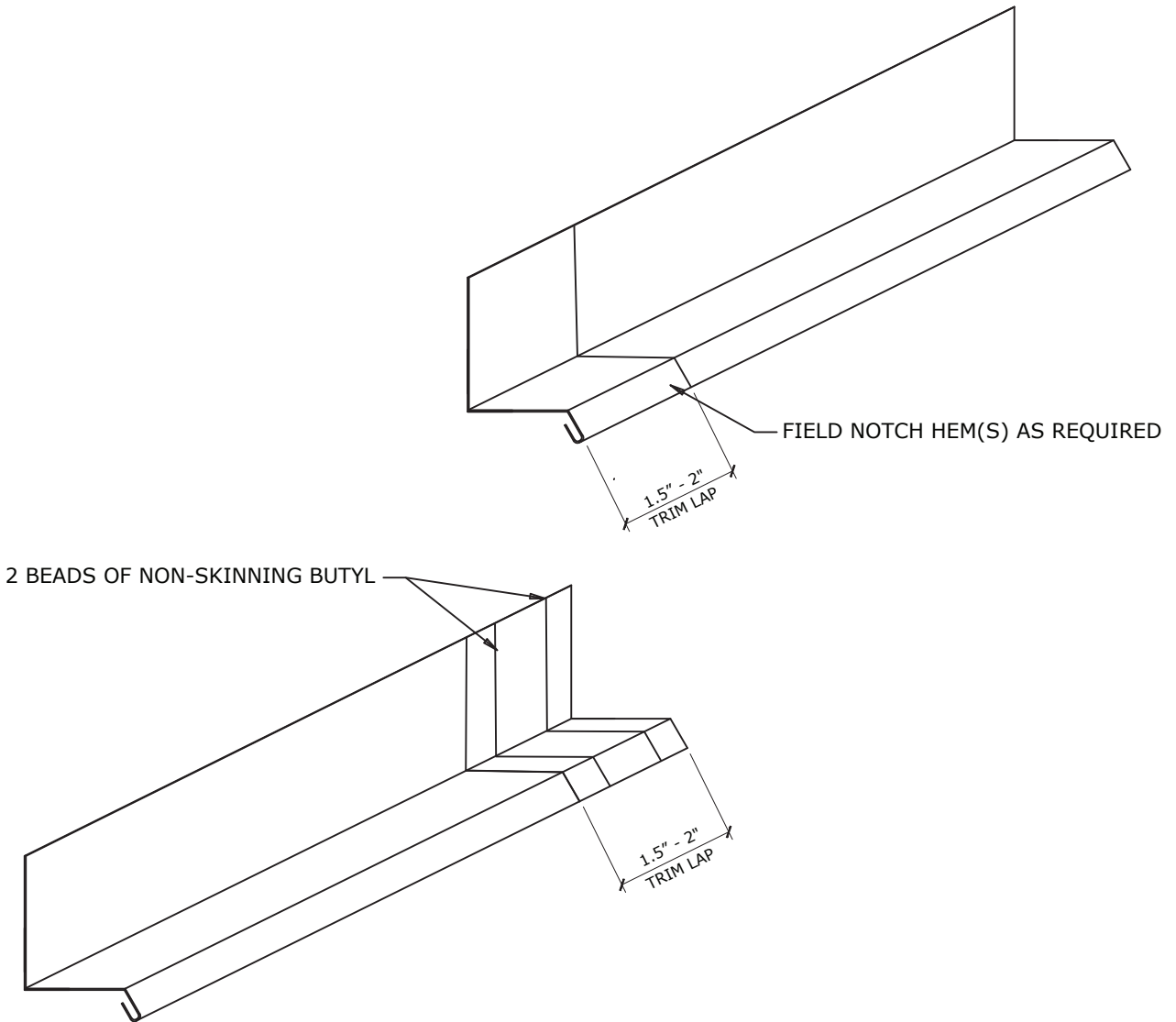

NOTE:

- RIVET OR STITCH SCREW AS NECESSARY.

NOTES:

- A. DETAILS ARE FOR GUIDELINES ONLY, AND MAY NOT BE SUITABLE FOR ALL BUILDING DESIGNS AND CONDITIONS.
- B. SCREW LENGTHS MAY VARY PER CUSTOMER REQUEST.

PROFILE

IMP WALL PANELS

APPLICATION

COMMERCIAL - INDUSTRIAL

DETAIL

TRIM END LAP - CORNER

TYPE

HF-1000

DATE

MAY 1/22

REV.

A

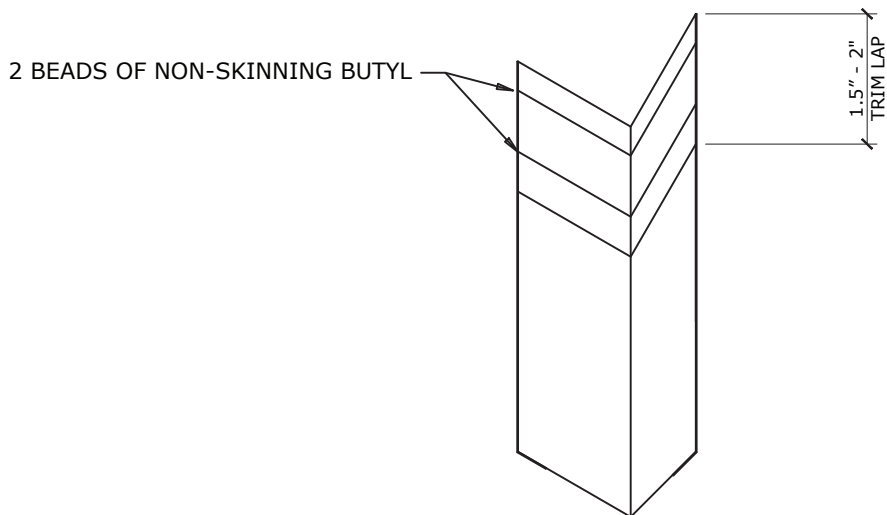
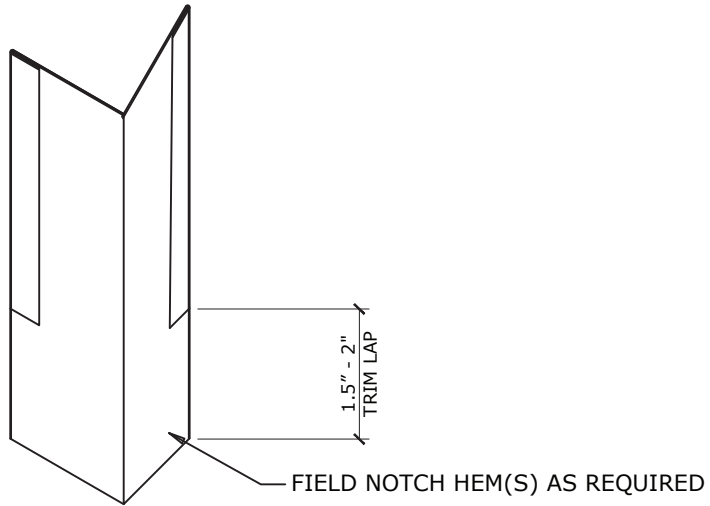

NOTE:
- RIVET OR STITCH SCREW AS NECESSARY.

NOTES:
A. DETAILS ARE FOR GUIDELINES ONLY, AND MAY NOT BE SUITABLE FOR ALL BUILDING DESIGNS AND CONDITIONS.
B. SCREW LENGTHS MAY VARY PER CUSTOMER REQUEST.

PROFILE

IMP WALL PANELS

APPLICATION

COMMERCIAL - INDUSTRIAL

DETAIL

TRIM END LAP - TWO PIECE JAMB

TYPE

HF-1000

DATE

MAY 1/22

REV.

A

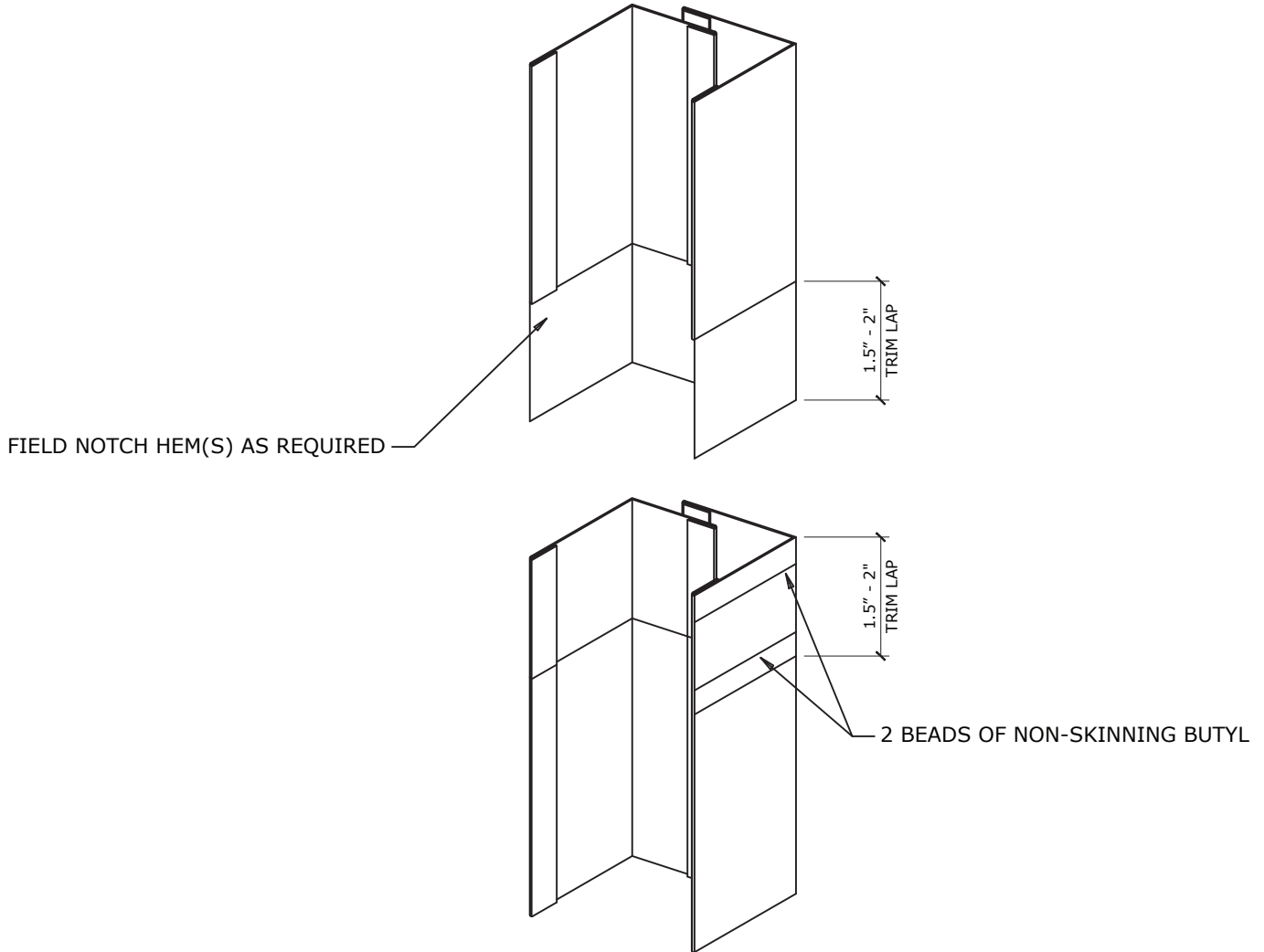

NOTE:

- RIVET OR STITCH SCREW AS NECESSARY.

NOTES:

- A. DETAILS ARE FOR GUIDELINES ONLY, AND MAY NOT BE SUITABLE FOR ALL BUILDING DESIGNS AND CONDITIONS.
- B. SCREW LENGTHS MAY VARY PER CUSTOMER REQUEST.

PROFILE

C-CHANNEL LAP - TOP OF WALL AND CAPING

APPLICATION

COMMERCIAL - INDUSTRIAL

TYPE

HF-1000

DATE

MAY 1/22

REV.

A

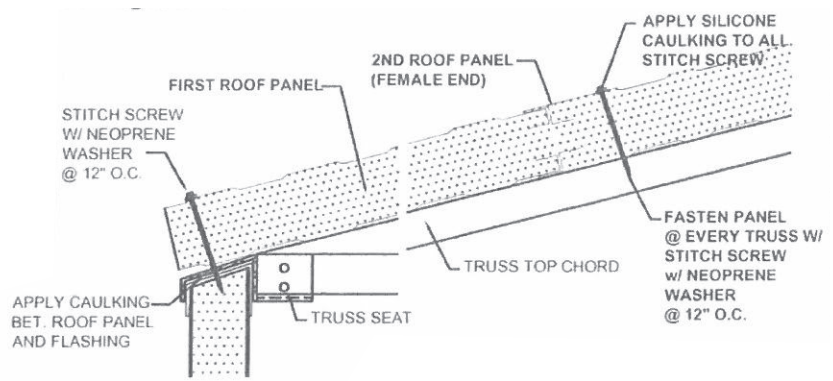
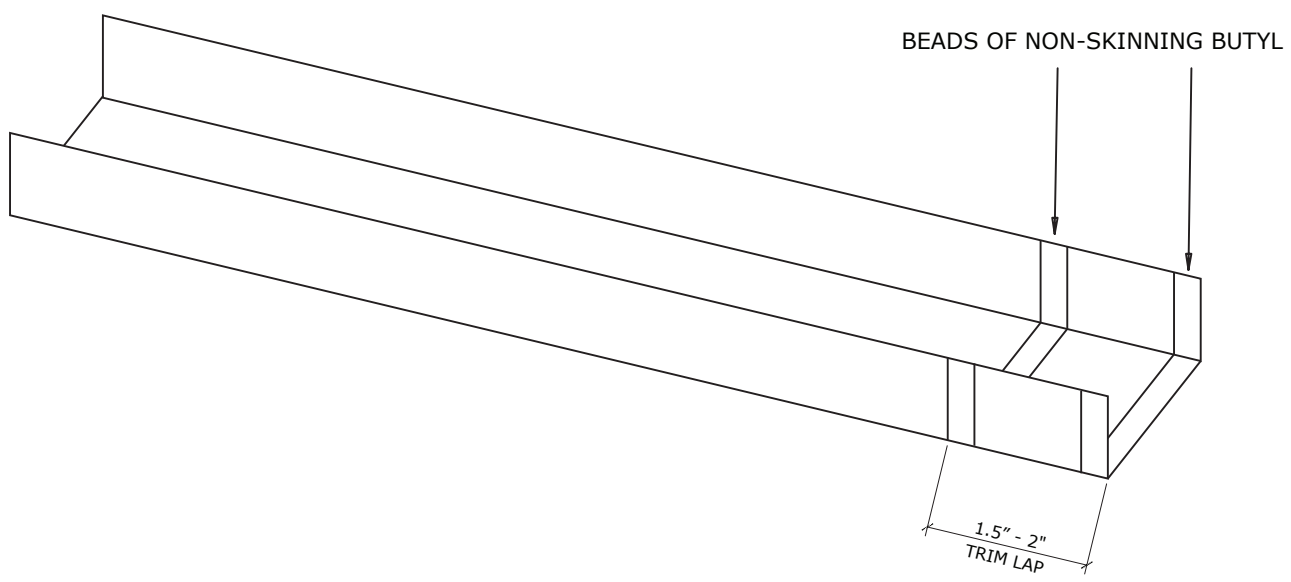

NOTES:

- A. DETAILS ARE FOR GUIDELINES ONLY, AND MAY NOT BE SUITABLE FOR ALL BUILDING DESIGNS AND CONDITIONS.
- B. SCREW LENGTHS MAY VARY PER CUSTOMER REQUEST.

PROFILE

IMP WALL PANELS

APPLICATION

COMMERCIAL - INDUSTRIAL

DETAIL

TRIM END LAP - SILL

TYPE

HF-1000

DATE

MAY 1/22

REV.

A

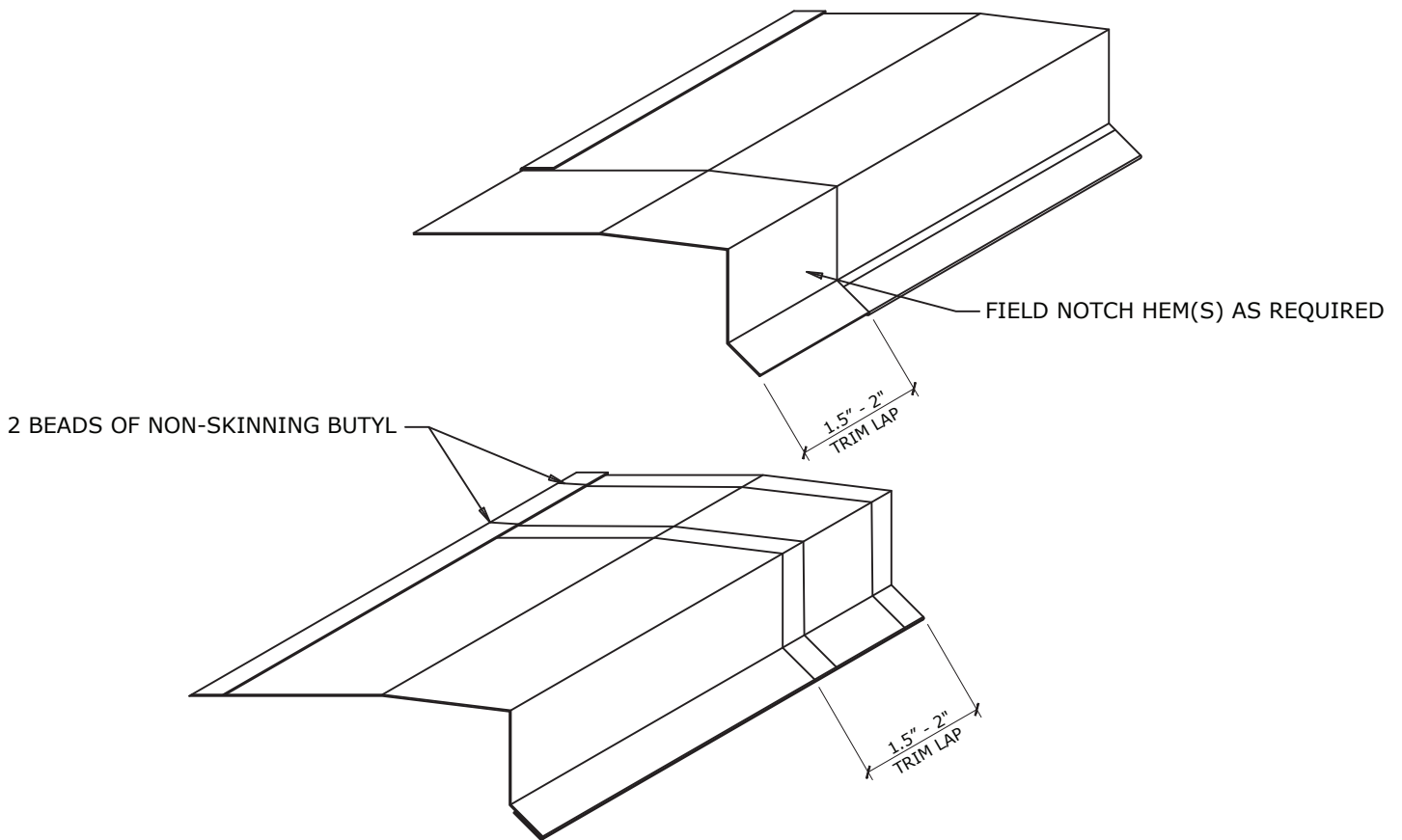

NOTE:
- RIVET OR STITCH SCREW AS NECESSARY.

PROFILE

IMP WALL PANELS

APPLICATION

COMMERCIAL - INDUSTRIAL

DETAIL

TRIM END LAP - SILL

TYPE

HF-1000

DATE

MAY 1/22

REV.

A

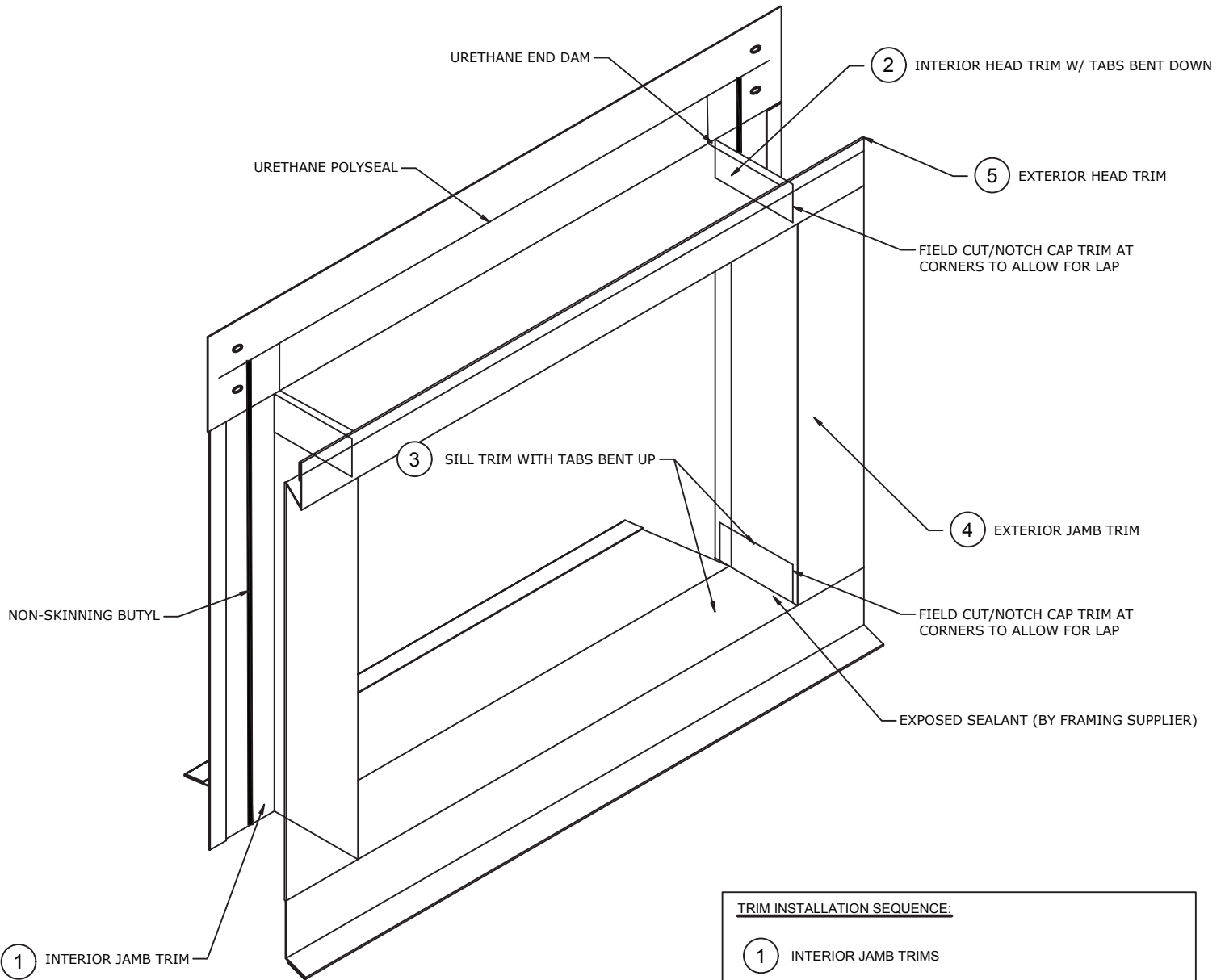

TRIM INSTALLATION SEQUENCE:

- 1 INTERIOR JAMB TRIMS
- 2 INTERIOR HEAD TRIM WITH TABS BENT DOWN, NOTCHED
- 3 SILL TRIM WITH TABS BENT UP, NOTCHED
- 4 EXTERIOR JAMB TRIMS
- 5 EXTERIOR HEAD TRIM

NOTES:
 A. DETAILS ARE FOR GUIDELINES ONLY, AND MAY NOT BE SUITABLE FOR ALL BUILDING DESIGNS AND CONDITIONS.
 B. SCREW LENGTHS MAY VARY PER CUSTOMER REQUEST.